

Crestron **CPC-LMT**  
CPC Lens Mount Accessory

---

Operations & Installation Guide



# Contents

- Lens Mount Accessory: CPC-LMT** **1**
- Description ..... 1
  - Functional Description..... 1
  - Physical Description..... 1
- Installation ..... 2
  - CPC-LMT Exploded View..... 4
- Problem Solving..... 5
  - Troubleshooting ..... 5
  - Further inquiries ..... 5
- Return Warranty Policies..... 6
  - Merchandise Returns / Repair Service..... 6
  - CRESTRON Limited Warranty..... 6



# Lens Mount Accessory: CPC-LMT

---

## Description

### Functional Description

The CPC-LMT is an accessory for the Crestron CPC-CAMI. This accessory provides simple flexibility in mounting a camera/lens assembly. Its unique design eliminates the need for custom plate assemblies. The CPC-LMT mounts quickly and rigidly supports both camera and lens.

### Physical Description

The CPC-LMT is constructed of anodized aluminum and finished in a semi-gloss black color. The CPC-LMT consists mainly of three mounting plates that have adjustable mounting hole spacing. This allows the CPC-LMT to adjust quickly to different camera/lens assemblies.

*CPC-LMT: Physical View*

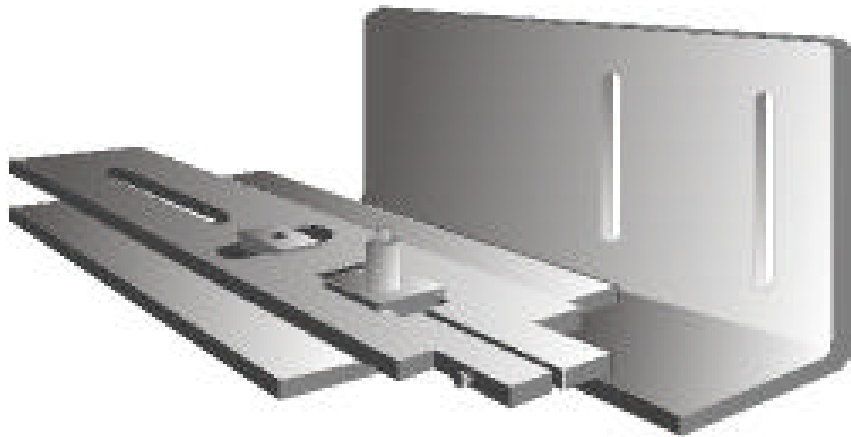

---

# Installation

The CPC-LMT is delivered assembled. Depending on the camera and lens that is going to be used, the CPC-LMT requires adjustment. The parts bag shipped with the unit includes tools for adjustments and a spacer for camera mounting. A Phillips tip screwdriver and hex keys (supplied) are all the hand tools necessary to mount the CPC-LMT.

### Parts Bag Contents

QTY.	ITEM
1	Hex Key (9/64)
1	Hex Key (.050)
1	Hex Key (5/32)
1	Screw 1/4-20x3/4
1	Spacer

---

**NOTE:** Before beginning this installation, remove the mounting plates from the CPC-CAMI and retain the two 1/4-20 x 3/8 mounting screws. The CPC-LMT is installed using these two 1/4-20 x 3/8 mounting screws.

---

### Important:

Call-out numbers refer to the "CPC-LMT Exploded View" on page 4, unless noted otherwise.

1. Assemble the camera and lens to be mounted. Align the camera and lens mounting holes. Note the distance between the camera and lens mounting screws and make sure that they fit into the **Adjustment Slots** of the **Camera Plate (5)**. There should be excess room to allow for forward/backward adjustment.
2. Determine the center balance point of the camera/lens assembly. This can be achieved by placing the camera/lens on a flat surface and inserting a pencil or similar object beneath the assembly to determine the balance point. Note the balance point. It should be located at the center of rotation on the CPC-CAMI. The center of rotation is indicated by **Pins (16)** on the **Platform Support Bracket (1)**.
3. In most cases the **Lens (14)** is physically larger than the **Camera (15)**. If so, discard **Spacer (12)**. If the **Camera (15)** is larger than the **Lens (14)**, **Spacer (12)** should be used as shown below.

### Proper Use of Spacer

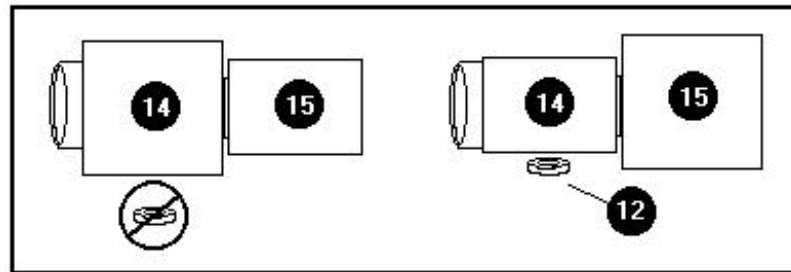

---

**NOTE:** If **Spacer (12)** is used, the 3/4 inch long **Screw (11A)** must be used.

---

4. Remove **Camera Support Rod (9)** from the CPC-LMT assembly by loosening **Locking Screw (13)**.

5. Screw the **Camera Support Rod (9)** into the camera's mounting hole. If the camera has multiple mounting holes, choose the hole that allows the **Adjustment Block (8)** to fit into the adjustment slot in the **Camera Mount Plate (5)**.
6. Insert **Camera Support Rod (9)** into the in the **Adjustment Block (8)**.
7. Position the camera /lens assembly (**14**) and (**15**) on the **Camera Mounting Plate (5)**.
8. Insert the **Adjustment Block (8)** into the adjustment slot of the **Camera Mount Plate (5)**.
9. Position the camera/lens assembly so the balance point is as close to **Mounting Block (6)** as possible.
10. Tighten lens **Screw (11)** or (**11A**) with a Phillips tip screwdriver.
11. Tighten **Locking Screws (10)** and (**13**) with the hex keys provided.
12. Hex **Screws (4)** and washers (**17**) provide additional front to back adjustment. If necessary, select a pair of holes in the **Interim Plate (3)** that would allow proper balancing.
13. The CPC-LMT has two width adjustments. Use either the **Adjustment Block (6)** or the **slots** in the **Platform Support Arm (1)** to adjust for various camera/lens widths.
14. After proper positioning of the camera/lens assembly, tighten **Screws (4)** and (**17**).
15. The camera/lens and CPC-LMT are now one assembly. Adjust the assembly's height to align the center of the lens with the center of tilt rotation.
16. Check all CPC-LMT screws for tightness.
17. Fit the camera and CPC-LMT assembly onto the CPC-CAMI by aligning the **Pins (16)** with the slots of the CPC-CAMI.
18. Secure the CPC-LMT to the CPC-CAMI with the two ¼-20 **Screws (2)**.

# CPC-LMT Exploded View

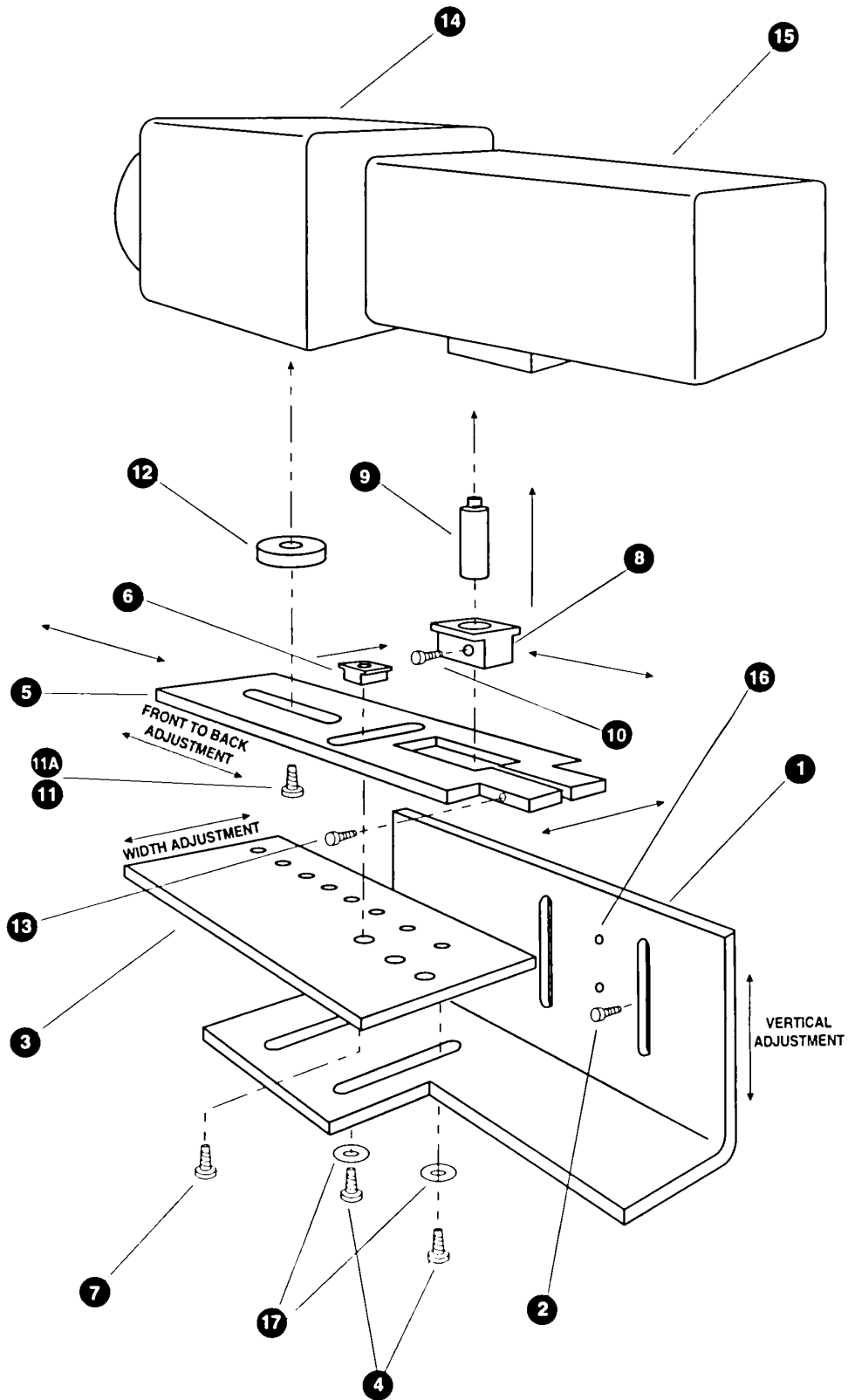



---

# Problem Solving

## Troubleshooting

The CPC-LMT is designed to be flexible enough to mount to most camera/lens configurations. If further assistance is required, please contact a Crestron technical support representative. Refer to "Further Inquiries" below.

## Further Inquiries

If after reviewing this Operations & Installation Guide, you cannot locate specific information or have questions, please take advantage of Crestron's award winning technical support team by calling:

- In the US and Canada, call Crestron's corporate headquarters at 1-888-CRESTRON [1-888-273-7876] or 1-201-767-3400.
- In Europe, call Crestron International at +32-15-50-99-50.
- In Asia, call Crestron Asia at +852-2341-2016.
- In Latin America, call Crestron Latin America at +525-574-15-90.

For local support from exclusive Crestron factory-trained personnel call:

- In Australia, call Soundcorp at +613-941-61066.
- In New Zealand, call Amber Technologies at +649-410-8382.

---

# Return Warranty Policies

## Merchandise Returns / Repair Service

1. No merchandise may be returned for credit, exchange, or service without prior authorization from CRESTRON. To obtain warranty service for CRESTRON products, contact the factory and request an RMA (Return Merchandise Authorization) number. Enclose a note specifying the nature of the problem, name and phone number of contact person, RMA number, and return address.
2. Products may be returned for credit, exchange, or service with a CRESTRON Return Merchandise Authorization (RMA) number. Authorized returns must be shipped freight prepaid to CRESTRON, Cresskill, N.J., or its authorized subsidiaries, with RMA number clearly marked on the outside of all cartons. Shipments arriving freight collect or without an RMA number shall be subject to refusal. CRESTRON reserves the right in its sole and absolute discretion to charge a 15% restocking fee, plus shipping costs, on any products returned with an RMA.
3. Return freight charges following repair of items under warranty shall be paid by CRESTRON, shipping by standard ground carrier. In the event repairs are found to be non-warranty, return freight costs shall be paid by the purchaser.

## CRESTRON Limited Warranty

CRESTRON ELECTRONICS, Inc. warrants its Cresnet II products, denoted by a "CN" prefix model number, to be free from manufacturing defects in materials and workmanship for a period of three (3) years from the date of shipment to purchaser. Disk drives and any other moving or rotating mechanical parts are covered for a period of one (1) year. CRESTRON warrants all its other products for a period of one year from the defects mentioned above, excluding touchscreen display components which are covered for 90 days. Incandescent lamps are completely excluded from Crestron's Limited Warranty. CRESTRON shall, at its option, repair or replace any product found defective without charge for parts or labor. Repaired or replaced equipment and parts supplied under this warranty shall be covered only by the unexpired portion of the warranty.

CRESTRON shall not be liable to honor warranty terms if the product has been used in any application other than that for which it was intended, or if it has been subjected to misuse, accidental damage, modification, or improper installation procedures. Furthermore, this warranty does not cover any product that has had the serial number altered, defaced, or removed.

This warranty shall be the sole and exclusive remedy to the purchaser. In no event shall CRESTRON be liable for incidental or consequential damages of any kind (property or economic damages inclusive) arising from the sale or use of this equipment. CRESTRON makes no other warranties nor authorizes any other party to offer any warranty, expressed or implied, including warranties of merchantability for this product. This warranty statement supersedes all previous warranties.

### Trademark Information

*All brand names, product names, and trademarks are the sole property of their respective owners. Windows is a registered trademark of Microsoft Corporation. Windows95, Windows98 and WindowsNT are trademarks of Microsoft Corporation*





**Crestron Electronics, Inc.**  
15 Volvo Drive Rockleigh, NJ 07647  
Tel: 888.CRESTRON / 201.767.3400  
Fax: 201.767.7576 / BBS: 201.767.5506  
[www.crestron.com](http://www.crestron.com)

*Specifications  
subject to change  
without notice.*

Doc. 5758  
12.98

