

Crestron **CPC-WMT**  
CPC Wall Mount Accessory

---

Operations & Installation Guide



# Contents

## Wall Mount Accessory: CPC-WMT

Description	.....	.....
Functional Description	.....	1
Installation	.....	.....
Problem Solving	.....	.....
Troubleshooting	.....	.....
Further inquiries	.....	.....
Return Warranty Policies	.....	.....
Merchandise Returns / Repair Service	.....	5
	.....	.....

---



---

# CPC-WMT

---

## Description

### Functional Description

The CPC-WMT is an accessory for the Crestron CPC-CAMI. This accessory is designed as a wall mount for the CPC-CAMI. It offers an attractive design that easily mounts to various surfaces.

### Physical Description

Constructed of durable powdercoated steel, the CPC-WMT is at home in any environment. The overall length of the CPC-WMT is 16.25 inches (41.28 cm) and should provide sufficient clearance for most of today's camera/lens assemblies. The maximum load rating is 40 pounds (88 kg). Two 1/4-20x1/2 inch screws attach the CPC-CAMI to the CPC-WMT.

*CPC-WMT: Physical View*

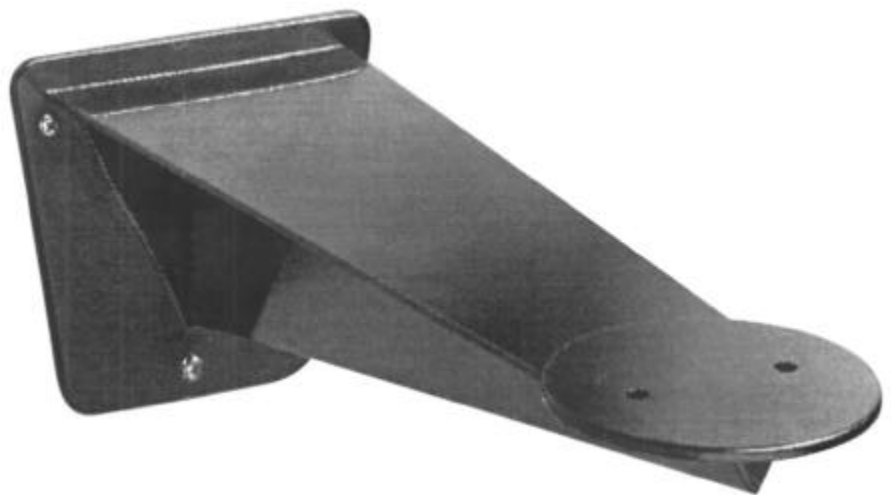

# Installation

The parts bag shipped with the unit includes tools and hardware for camera mounting. The hex keys (supplied) are necessary to mount the CPC-CAMI to the CPC-WMT.

*Parts Bag Contents*

CPC-WMT

QTY.	ITEM
1	Hex Key 3/16
2	Screw 1/4-20x1/2

1. Pick a desirable location to mount the **CPC-WMT** (hardware not supplied). Ensure that the mounting surface can support the weight of the camera/mount assembly. Make sure the location allows for full movement of the camera/lens assembly.

---

**NOTE:** A template (latest revision of DOC. 5770) is supplied to properly locate the three **CPC-WMT** mounting holes.

---

2. Mount the **CPC-CAMI** to the **CPC-WMT** using the two 1/4-20x1/2 inch screws (supplied).

---

**NOTE:** It is important to provide a free loop of cable when installing a moving camera/lens assembly. Provide enough excess cable to allow the camera to move freely through its range. This practice reduces strain on the **CPC-CAMI** and can extend motor life.

---

*CPC-WMT: Mechanical Specifications*

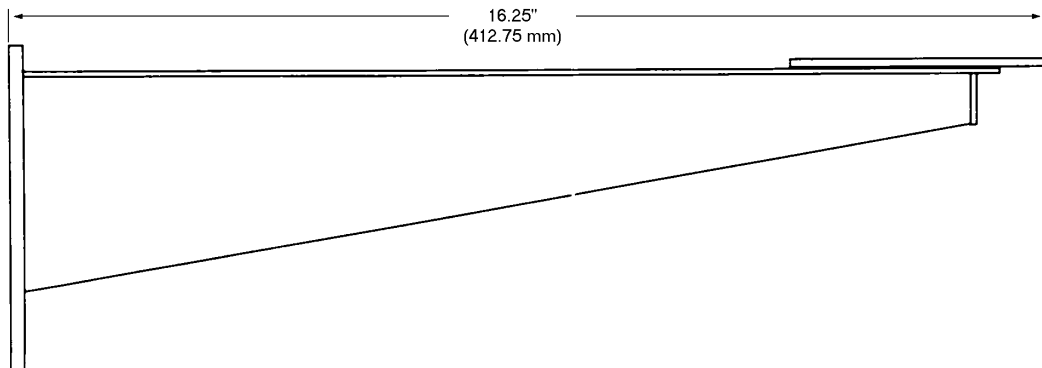

*CPC-WMT: Mechanical Specifications (continued)*

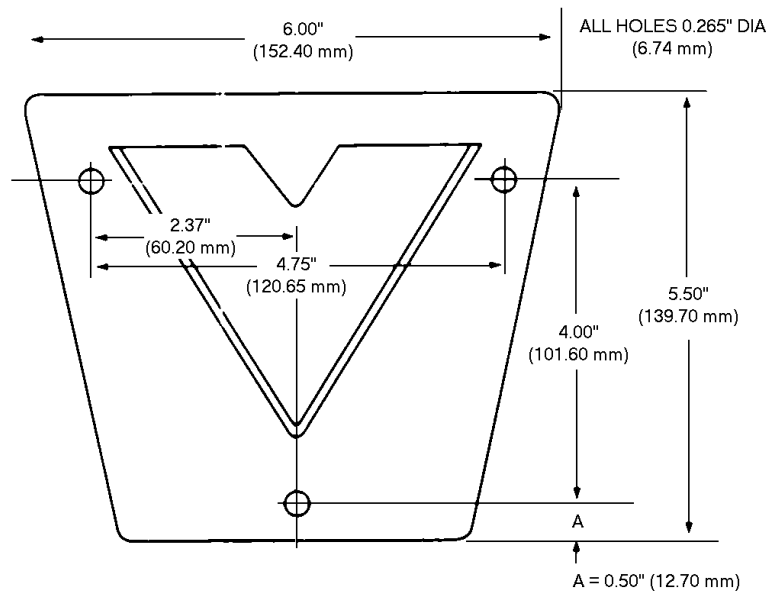
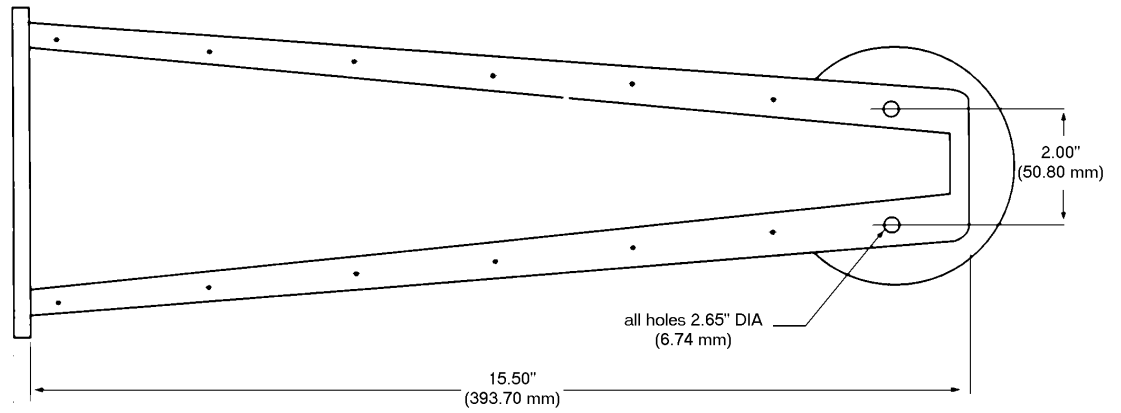

## Problem Solving

### Troubleshooting

If further assistance is required, please contact a Crestron technical support representative. Refer to "Further Inquiries" below.

### Further Inquiries

If after reviewing this Operations & Installation Guide, you cannot locate specific information or have questions, please take advantage of Crestron's award winning technical support team by calling:

- In the US and Canada, call Crestron's corporate headquarters at 1-888-CRESTRON [1-888-273-7876] or 1-201-767-3400.
- In Europe, call Crestron International at +32-15-50-99-50.
- In Asia, call Crestron Asia at +852-2341-2016.
- In Latin America, call Crestron Latin America at +525-574-15-90.

For local support from exclusive Crestron factory-trained personnel call:

- In Australia, call Soundcorp at +613-941-61066.
- In New Zealand, call Amber Technologies at +649-410-8382.



## Return Warranty Policies

### Merchandise Returns / Repair Service

1. No merchandise may be returned for credit, exchange, or service without prior authorization from CRESTRON. To obtain warranty service for CRESTRON products, contact the factory and request an RMA (Return Merchandise Authorization) number. Enclose a note specifying the nature of the problem, name and phone number of contact person, RMA number, and return address.
2. Products may be returned for credit, exchange, or service with a CRESTRON Return Merchandise Authorization (RMA) number. Authorized returns must be shipped freight prepaid to CRESTRON, Cresskill, N.J., or its authorized subsidiaries, with RMA number clearly marked on the outside of all cartons. Shipments arriving freight collect or without an RMA number shall be subject to refusal. CRESTRON reserves the right in its sole and absolute discretion to charge a 15% restocking fee, plus shipping costs, on any products returned with an RMA.
3. Return freight charges following repair of items under warranty shall be paid by CRESTRON, shipping by standard ground carrier. In the event repairs are found to be non-warranty, return freight costs shall be paid by the purchaser.

### CRESTRON Limited Warranty

CRESTRON ELECTRONICS, Inc. warrants its Cresnet II products, denoted by a "CN" prefix model number, to be free from manufacturing defects in materials and workmanship for a period of three (3) years from the date of shipment to purchaser. Disk drives and any other moving or rotating mechanical parts are covered for a period of one (1) year. CRESTRON warrants all its other products for a period of one year from the defects mentioned above, excluding touchscreen display components which are covered for 90 days. Incandescent lamps are completely excluded from Crestron's Limited Warranty. CRESTRON shall, at its option, repair or replace any product found defective without charge for parts or labor. Repaired or replaced equipment and parts supplied under this warranty shall be covered only by the unexpired portion of the warranty.

CRESTRON shall not be liable to honor warranty terms if the product has been used in any application other than that for which it was intended, or if it has been subjected to misuse, accidental damage, modification, or improper installation procedures. Furthermore, this warranty does not cover any product that has had the serial number altered, defaced, or removed.

This warranty shall be the sole and exclusive remedy to the purchaser. In no event shall CRESTRON be liable for incidental or consequential damages of any kind (property or economic damages inclusive) arising from the sale or use of this equipment. CRESTRON makes no other warranties nor authorizes any other party to offer any warranty, expressed or implied, including warranties of merchantability for this product. This warranty statement supersedes all previous warranties.

#### Trademark Information

*All brand names, product names, and trademarks are the sole property of their respective owners. Windows is a registered trademark of Microsoft Corporation. Windows95, Windows98 and WindowsNT are trademarks of Microsoft Corporation*



**Crestron Electronics, Inc.**  
15 Volvo Drive Rockleigh, NJ 07647  
Tel: 888.CRESTRON / 201.767.3400  
Fax: 201.767.7576 / BBS: 201.767.5506  
[www.crestron.com](http://www.crestron.com)

*Specifications  
subject to change  
without notice.*

Doc. 5755  
12.98

