

Saros® 2-Way All Weather Surface Mount Indoor/Outdoor Speakers

Saros® speakers by Crestron deliver professional grade performance and flexible installation for demanding commercial or residential applications. The SAROS SMT6T-AW and SAROS SMT8T-AW series speakers support both surface and pole mounting. The speakers have a clean and contoured enclosure with weatherized construction, which can be mounted to most solid flat surfaces using the included brackets.



Installation

Prepare the Preconstruction Mounting Kit

1. Run the speaker wire (not included) from the amplifier to the speaker location.



In the Box

- 1 SAROS SMT Speaker

Additional Items

- 1 Wall mount bracket
- 1 Mounting yoke bracket
- 1 Grille
- 1 Grille adhesive
- 1 Grille removal hook
- 4 Wall anchor
- 4 Anchor screws
- 4 Wood screws
- 2 Torx™ M5 screws
- 1 Torx™ wrench
- 4 Washer
- 2 Screw, knob
- 1 Grommet plug

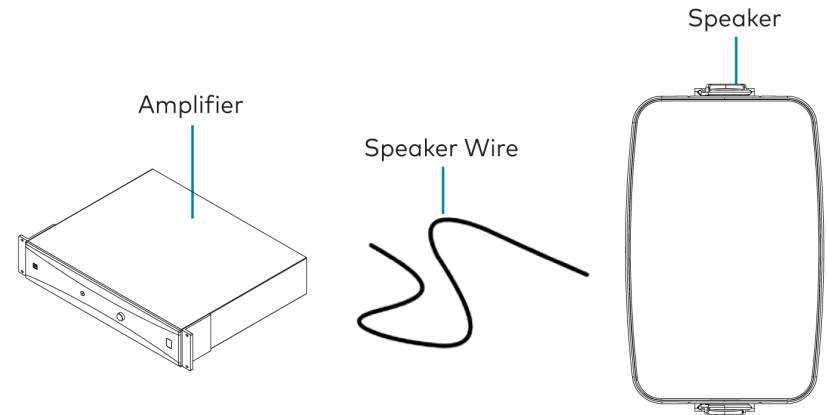

Saros® 2-Way All Weather Surface Mount Indoor/Outdoor Speakers

2. Attach the mounting bracket to the mounting surface using the included Torx™ wrench and either the four included wall anchors and anchor screws or the four included wood screws.

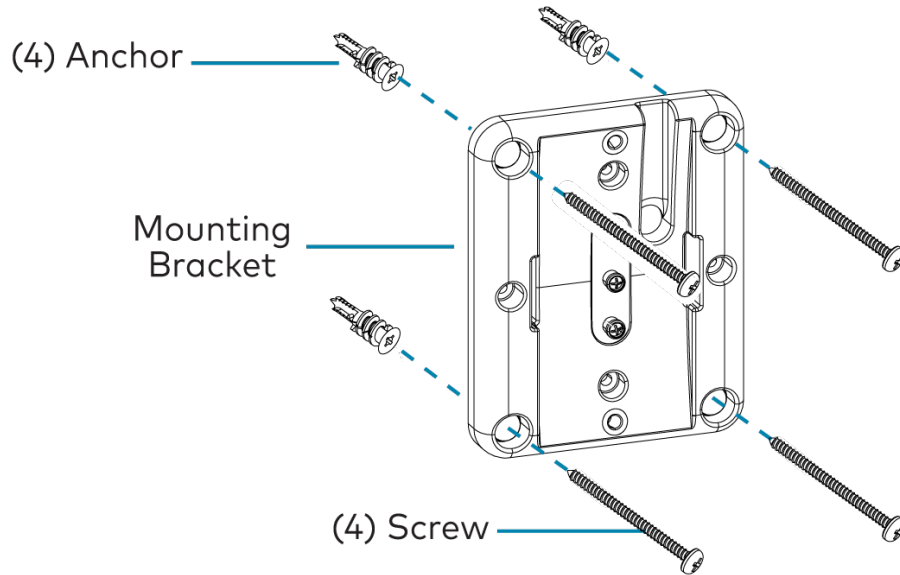

3. Pull the speaker wire through the indicated wire feed hole on the mounting bracket. Make sure to leave 18 to 24 in. slack in the wire in order to pass it through the wire opening in the speaker enclosure and connect it to the terminal block on the front of the speaker.

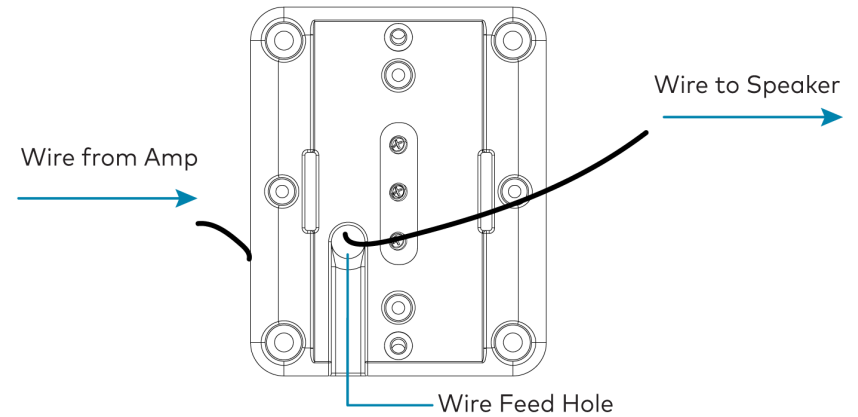

Optionally, to mount the speaker on a pole, secure the mounting bracket to the pole using a U-bolt (not included).

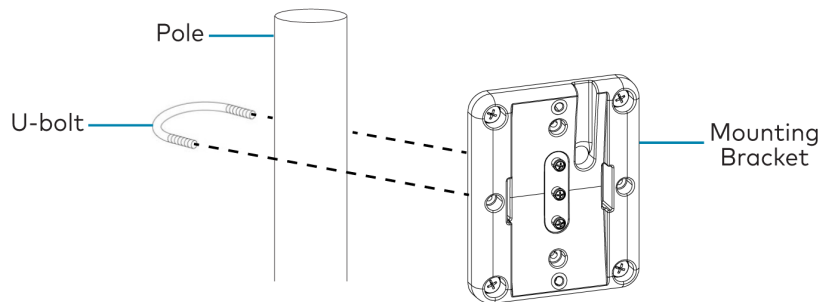

Saros® 2-Way All Weather Surface Mount Indoor/Outdoor Speakers

4. Select the desired pitch to attach the yoke bracket to the mounting bracket. Then, push the yoke bracket onto the three rubber nubs on the mounting bracket. Attach the yoke securely to the mounting bracket using the included Torx wrench and two Torx M5 screws.

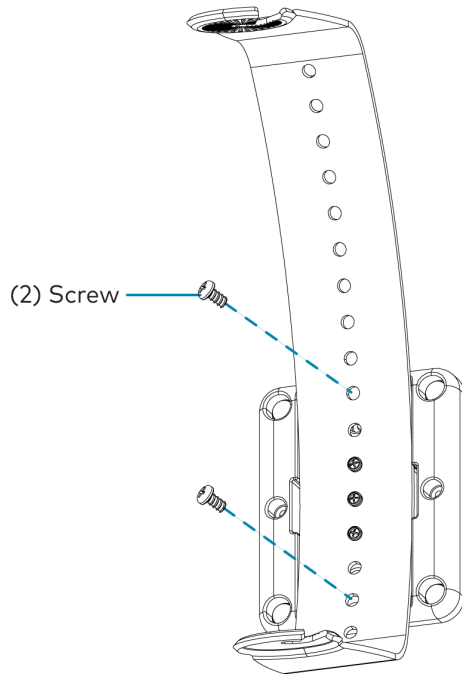

Attach the Speaker to the Mounting Kit

1. Open the wiring recess cover on the front panel of the speaker.

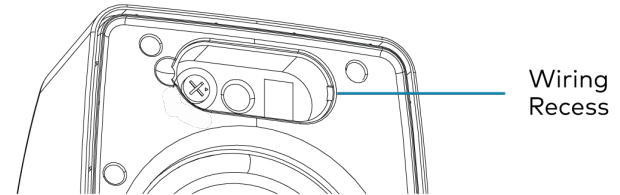

2. Feed the speaker wire slack at the mounting bracket through the wire opening in the speaker. Optionally, thread the speaker wire through the included grommet plug and insert the grommet plug into the wire opening at the rear of the speaker enclosure for additional weatherproofing.

Saros® 2-Way All Weather Surface Mount Indoor/Outdoor Speakers

3. Attach the speaker to the yoke bracket and adjust the horizontal angle:

a. Partially screw the knobs into the top and bottom of the speaker housing.

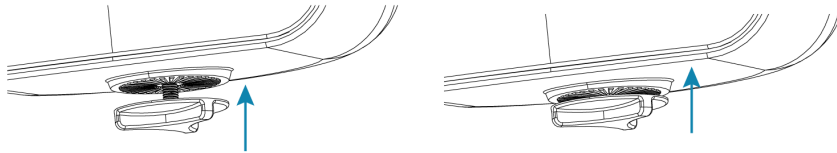

b. Slide the threaded portion of the knobs into the slots in the yoke bracket.

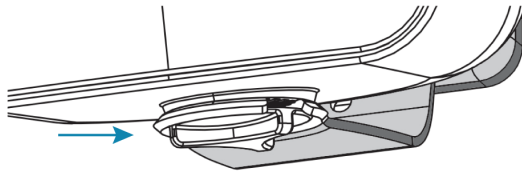

c. Tighten the knobs at the top and bottom to secure the speaker on the yoke bracket at the desired horizontal angle.

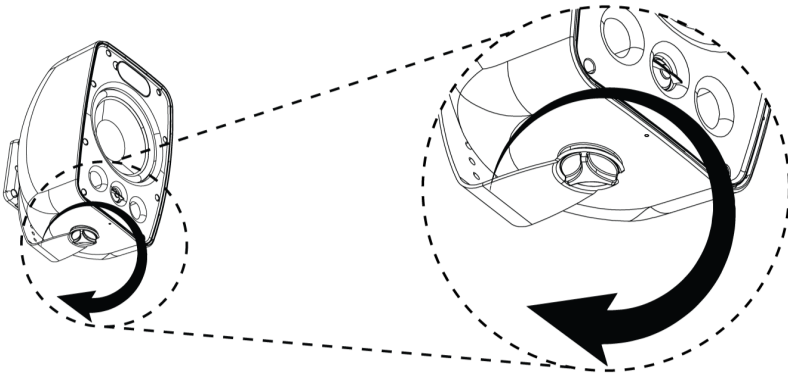

4. Connect the wire from the amplifier to the terminal block on the front speaker baffle:

a. Strip approximately 0.25 - 0.5 in. of the insulation off each wire, and twist at the end to avoid stray strands.

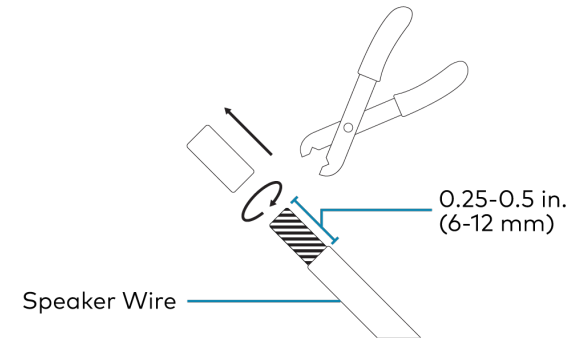

Saros® 2-Way All Weather Surface Mount Indoor/Outdoor Speakers

- b. Connect the wires from the amplifier (or the previous speaker) to the IN terminals of the supplied terminal block; connect positive to + and negative to -. Optionally, to wire another speaker in parallel, connect the OUT + and - terminals to the IN + and - terminals of the next speaker. Then, use a small flathead screwdriver to tighten the corresponding screw to secure the wire.

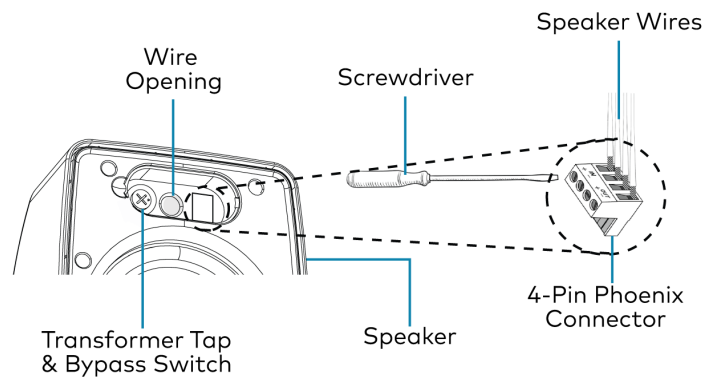

- c. When wiring multiple speakers in parallel (70V or 100V run), connect the OUT + and - terminals to the subsequent speaker's IN + and - terminals. Preserve proper polarity by connecting OUT + to IN + and OUT - to IN -.

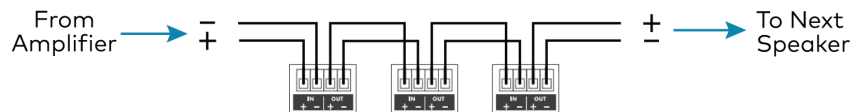

- d. If wiring for a 70V/100V distributed run, set the proper wattage for each speaker on the Transformer Tap selector on the front of the speaker.

The values on the outer ring of the label are the 100V settings, while the inner values are the 70V settings.

For example: The first position counterclockwise from the 8 ohms/OFF position corresponds to 7.5 W for a 70V system or 15 W for a 100V system.

NOTE: The 8 ohm position setting on the Transformer Tap selector bypasses the transformer completely. This setting should be used only for 8 ohm audio systems.

Then, replace the wiring recess cover into the recess on the speaker front panel .

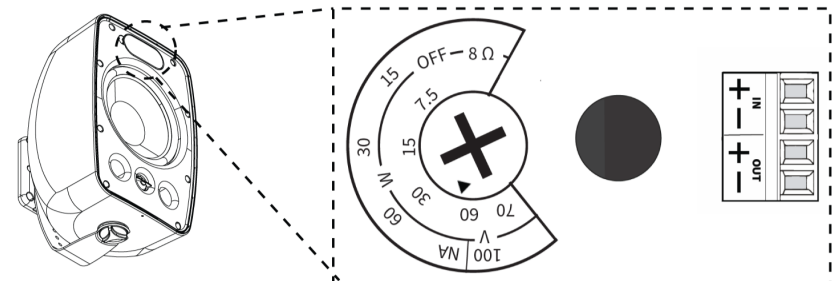

Saros® 2-Way All Weather Surface Mount Indoor/Outdoor Speakers

5. Fit the grille onto the speaker.
 - a. Optionally, to ensure a stronger hold of the grille in the channel, insert the included tacky adhesive into the channel of the speaker enclosure before inserting the grille.

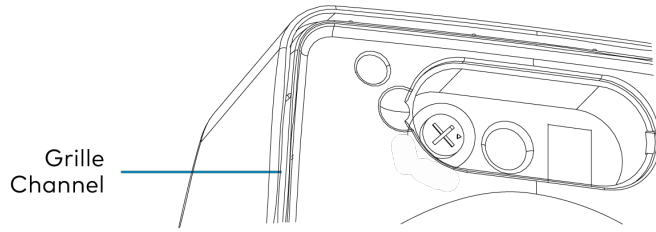

- b. Insert and press the grille into the channel of the speaker enclosure.

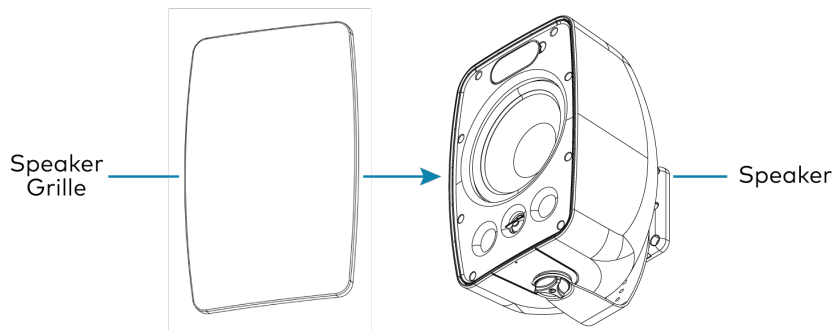

6. Fasten the grille in place using the two included security screws at the top and bottom of the speaker housing.



Visit the Product Page

Scan the QR code to visit the product page.

SAROS SMT6T-AW-B-T-EACH



www.crestron.com/model/6511862

SAROS SMT6T-AW-W-T-EACH



www.crestron.com/model/6511863

SAROS SMT8T-AW-B-T-EACH



www.crestron.com/model/6511864

SAROS SMT8T-AW-W-T-EACH



www.crestron.com/model/6511865

Saros® 2-Way All Weather Surface Mount Indoor/Outdoor Speakers

Additional Information

The original language version of this document is U.S. English.
All other languages are a translation of the original document.

Regulatory Model: M202046017

Crestron product development software is licensed to Crestron dealers and Crestron Service Providers (CSPs) under a limited nonexclusive, nontransferable Software Development Tools License Agreement. Crestron product operating system software is licensed to Crestron dealers, CSPs, and end-users under a separate End-User License Agreement. Both of these Agreements can be found on the Crestron website at www.crestron.com/legal/software_license_agreement.

The product warranty can be found at www.crestron.com/warranty.

The specific patents that cover Crestron products are listed online at www.crestron.com/legal/patents.

Certain Crestron products contain open source software. For specific information, please visit www.crestron.com/opensource.

Crestron, the Crestron logo, and Saros are either trademarks or registered trademarks of Crestron Electronics, Inc. in the United States and/or other countries. Torx is either a trademark or registered trademark of Acument Intellectual Properties, LLC in the United States and/or other countries. UL is either a trademark or registered trademark of Underwriters Laboratories, Inc. in the United States and/or other countries. Other trademarks, registered trademarks, and trade names may be used in this document to refer to either the entities claiming the marks and names or their products. Crestron disclaims any proprietary interest in the marks and names of others. Crestron is not responsible for errors in typography or photography.

©2024 Crestron Electronics, Inc.

Doc. 9053C

06/03/24