

Crestron **C2N-IIF-SPMK**
Intercom Interface Mounting Kit

Installation Guide



This document was prepared and written by the Technical Documentation department at:



Crestron Electronics, Inc.

15 Volvo Drive

Rockleigh, NJ 07647

1-888-CRESTRON

All brand names, product names and trademarks are the property of their respective owners.

©2004 Crestron Electronics, Inc.

Contents

Intercom Interface Mounting Kit: C2N-IIF-SPMK	1
Introduction	1
Features and Functions	1
Physical Description	1
Assembly	4
Further Inquiries	8
Future Updates	8
Return and Warranty Policies	9
Merchandise Returns / Repair Service	9
CRESTRON Limited Warranty	9

Intercom Interface Mounting Kit: C2N-IIF-SPMK

Introduction

Features and Functions

The Crestron[®] Intercom Interface Mounting Kit (C2N-IIF-SPMK) is used to install a C2N-IIF Intercom Interface into select door station products from Holovision[®]. The kit includes a speaker, microphone, and mounting hardware for attaching the C2N-IIF to door station plates from Holovision (sold separately).

Functional Summary

- Complete kit includes mounting plate, speaker and microphone assemblies, and mounting hardware
- Compatible with a variety of Holovision door station plates

Physical Description

The C2N-IIF-SPMK can be used with Holovision's gate entry boxes and door station plates as shown in the following diagrams.

C2N-IIF Mounted on Gate Entry Plate(L) and on Door Station Plate (R)

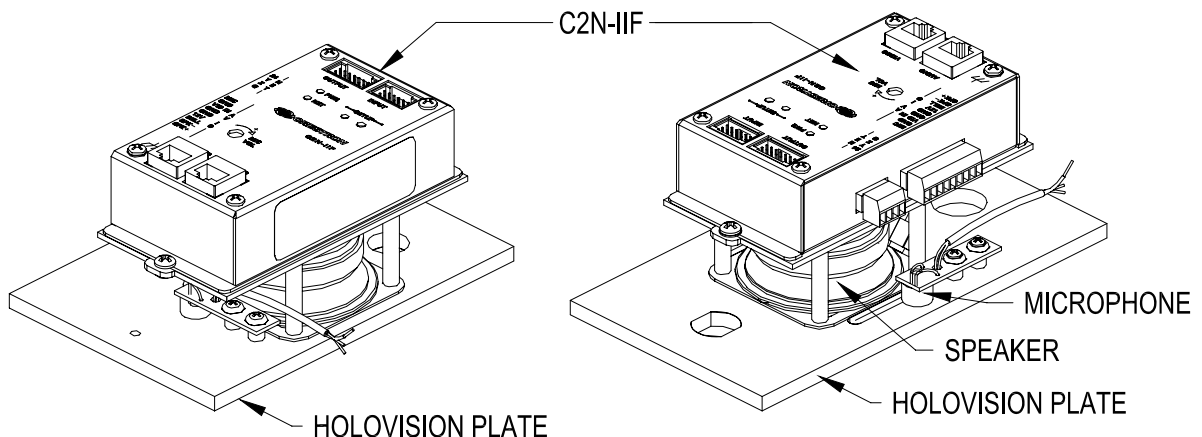

Dimensions for the C2N-IIF-SPMK are shown in the following diagram.

C2N-IIF-SPMK Physical Views

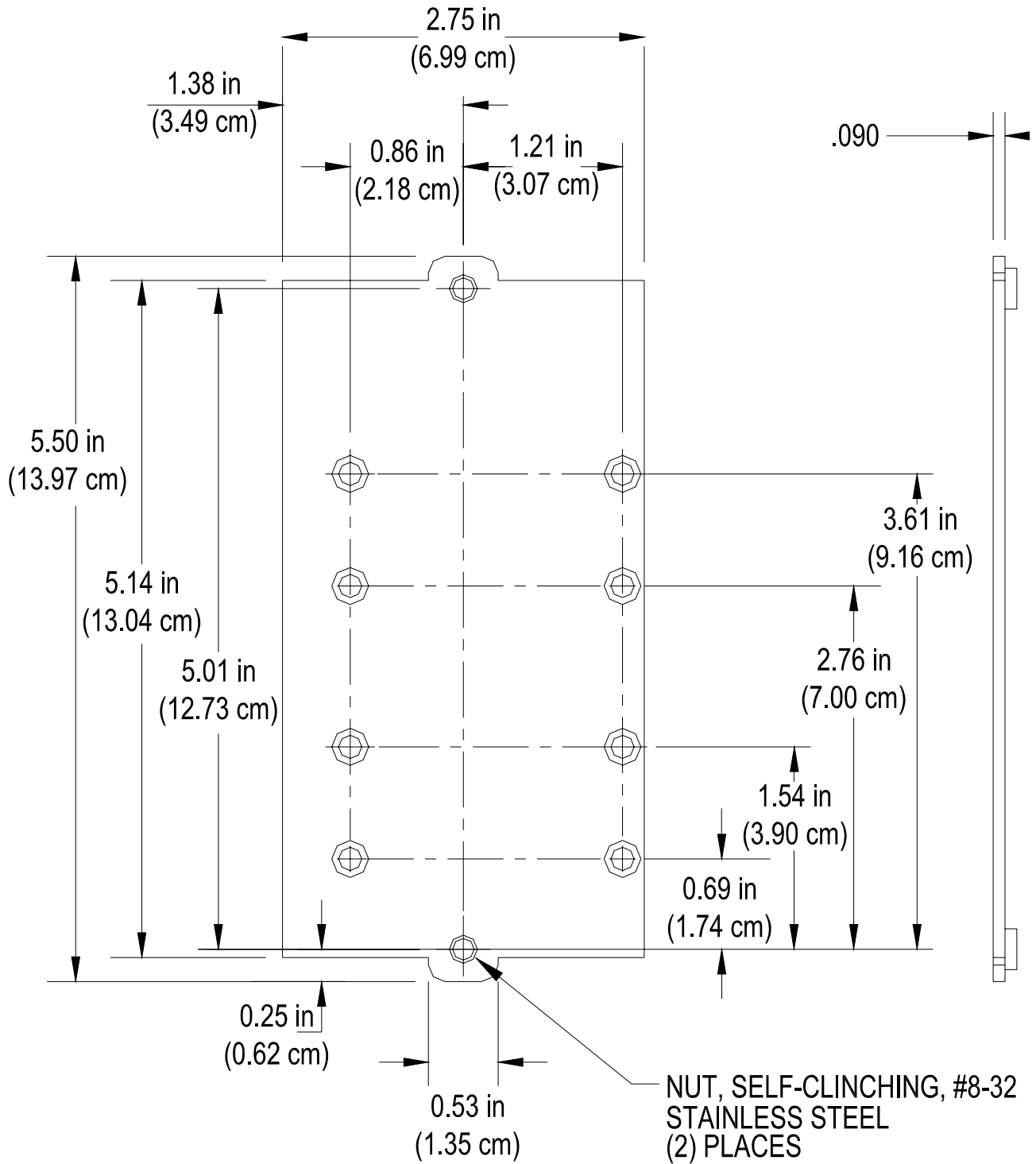

The C2N-IIF-SPMK includes all of the parts required for mounting a C2N-IIF to a Holovision door station plate. The following table lists all of the parts included with the C2N-IIF-SPMK.

Supplied Components

DESCRIPTION	PART NUMBER	QUANTITY
Mounting Plate	2010173	1
Screw, 08-32, 1/4" L, pan phillips	2007264	2
Screw, 06-32, 1 3/4" L, flat phillips	2010428	4
Spacer, 06, 1 7/16" L, round, 1/4" OD	2010427	4
Speaker Assembly	4005371	1
Microphone Assembly	4005461	1
Screw, 04-40, 3/4" L, pan phillips	2007184	2
Spacer, 04, 3/8" L, round, 1/4" OD	2007088	2
Washer, flat	2007658	2

The C2N-IIF-SPMK is compatible with the following Holovision door station models:

- Basic Model 100
- Camera Models 200 and 201
- Keyless Model 101
- Gate Entry Models: 300, 301, 302, and 303

NOTE: When ordering a Holovision plate, specify that the plate is to be used with a Crestron C2N-IIF. Older Holovision plates may not have the appropriate mounting provisions for the C2N-IIF-SPMK.

NOTE: If the C2N-IIF-SPMK is being used with a camera-capable door station plate, the camera is not included with the C2N-II-SPMK.

NOTE: The C2N-IIF-SPMK cannot be used with Holovision plates that use a camera hidden behind the speaker grate.

Assembly

Tools Required

- #2 Phillips tip screwdriver
- Tin Snips (for installation with a rough-in box)

Complete the following procedure in the order provided.

NOTE: When installing the C2N-IIF-SPMK with HoloVision's keypad-equipped plates, refer to Diagram A. For all other compatible HoloVision plates, refer to Diagram B.

NOTE: Observe the orientation of all components in the assembly diagrams to ensure proper fit.

1. Using the supplied 3/4" screws, washers, and 3/8" spacers, mount the microphone to the indicated location on the door station plate as shown in the following diagram. Tighten the screws 3/4 turn after making contact with the washers. Do not overtighten.

Securing the Microphone

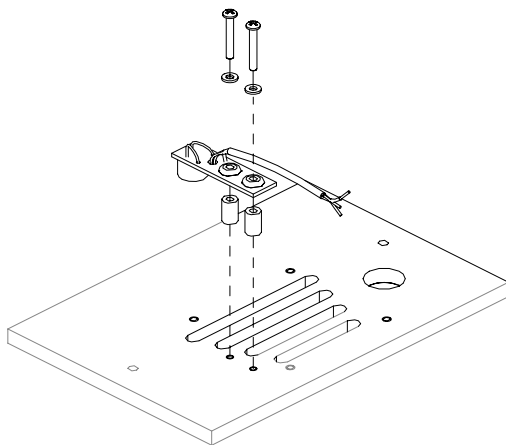

DIAGRAM A

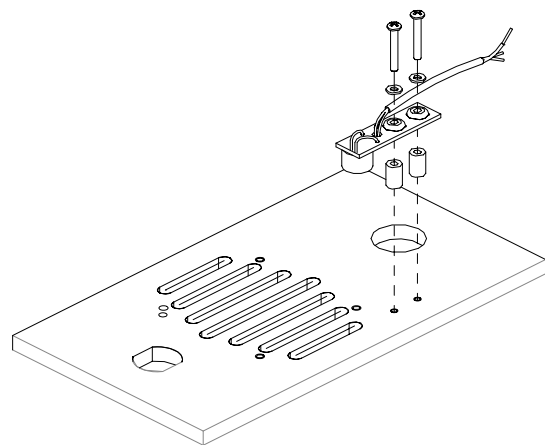

DIAGRAM B

2. As shown in the following diagram, position the speaker over the mounting holes in the door station plate.

Positioning the Speaker

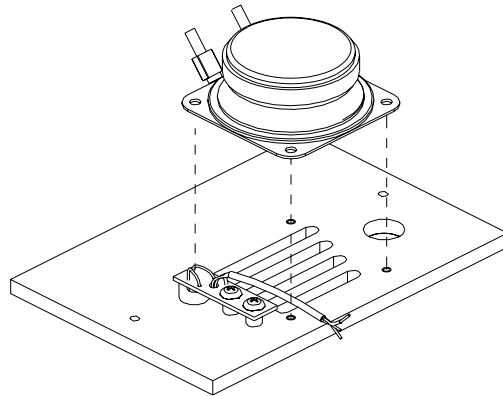

DIAGRAM A

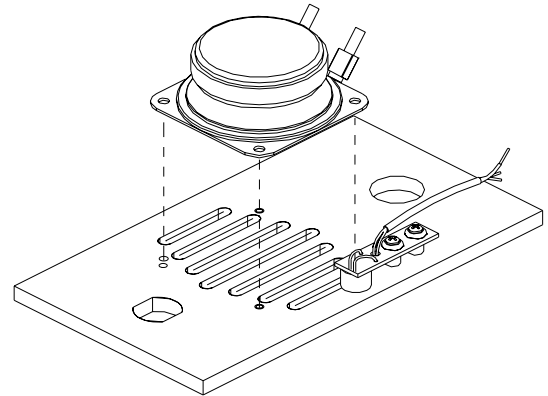

DIAGRAM B

3. Position the supplied 1 7/16" spacers over the speaker mounting holes as shown in the following diagram. Using the supplied 1 3/4" screws, secure the door station plate, speaker, and spacers to the appropriate holes on the mounting plate.

NOTE: Use a toothpick or small dowel to line up the parts during assembly.

Securing the Mounting Plate

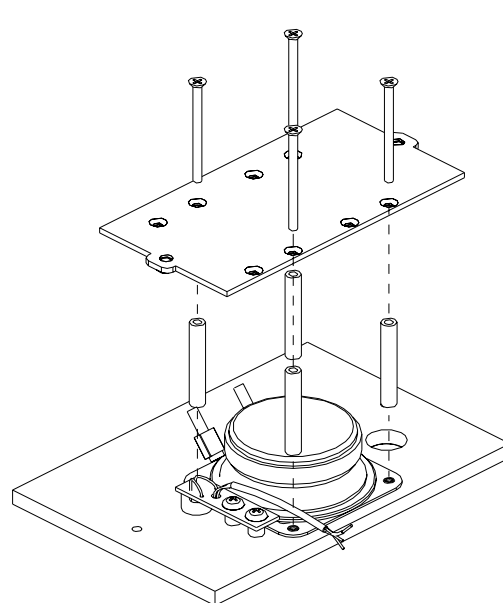

DIAGRAM A

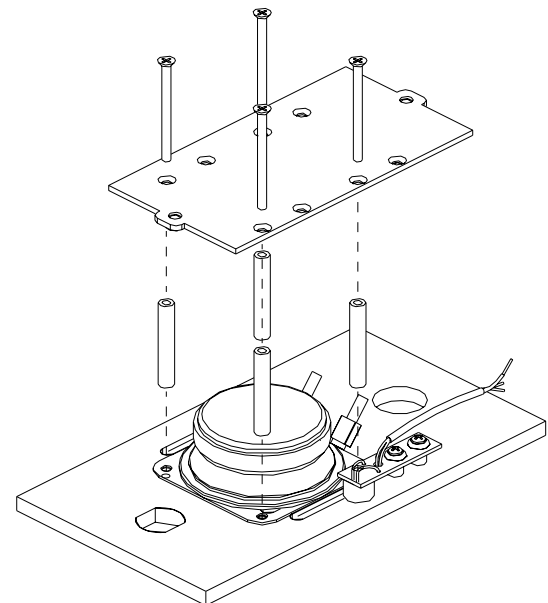

DIAGRAM B

NOTE: The nuts that are built in to the mounting plate should face the door station plate.

NOTE: Diagram A and Diagram B use different holes on the mounting plate to mount to the door station plate.

- Using the supplied 1/4" screws, secure the C2N-IIF to the mounting plate as shown in the following diagram.

Attaching the C2N-IIF to the Mounting Plate

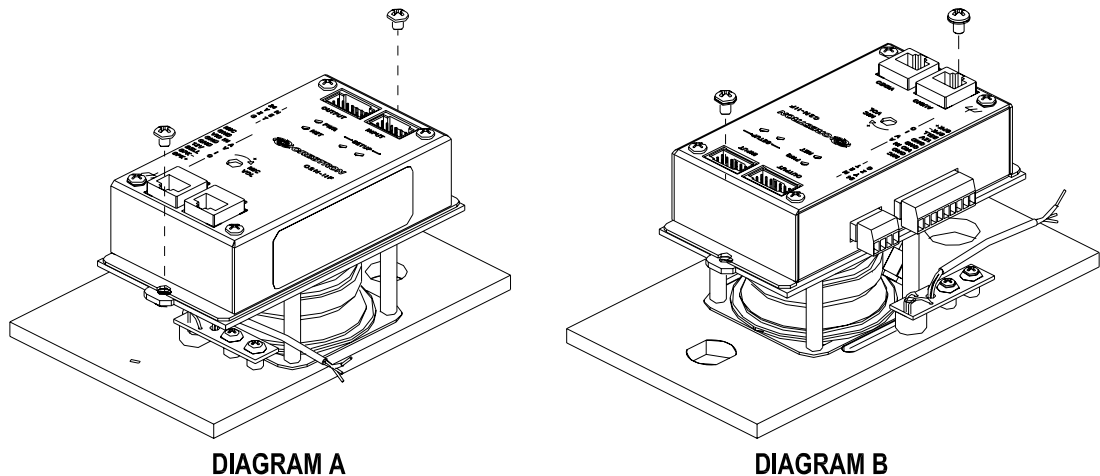

NOTE: The C2N-IIF must be placed on the mounting plate with the orientation shown in the diagrams.

5. Connect all wires to the C2N-IIF as described in the C2N-IIF Operation & Installation Guide (Doc. 6235) which can be downloaded from Downloads | Product Manuals section of the Crestron website (www.crestron.com).

NOTE: The red wire from the microphone is connected to the “MIC” terminal on the C2N-IIF. The black wire and shield wire are connected to the “GND” terminal located next to the “MIC” terminal.

6. Install the assembly per the instructions provided with the Holovision door plate.

To install into a Holovision rough-in box, tilt the assembly so the bottom can be placed in the box first and then shift the top of the assembly to the right, so the rest of the assembly can be placed in the box.

Further Inquiries

If you cannot locate specific information or have questions after reviewing this guide, please take advantage of Crestron's award winning customer service team by calling the Crestron corporate headquarters at 1-888-CRESTRON [1-888-273-7876]. For assistance in your local time zone, refer to the Crestron website (www.crestron.com) for a listing of Crestron worldwide offices.

You can also log onto the online help section of the Crestron website to ask questions about Crestron products. First-time users will need to establish a user account to fully benefit from all available features.

Future Updates

As Crestron adds improvements to the C2N-IIF-SPMK, additional information may be made available as manual updates. These updates are solely electronic and serve as intermediary supplements prior to the release of a complete technical documentation revision.

Check the Crestron website (www.crestron.com) periodically for manual update availability and its relevance. Updates are available from the Download | Product Manuals section and are identified as an “Addendum” in the Download column.

Return and Warranty Policies

Merchandise Returns / Repair Service

1. No merchandise may be returned for credit, exchange, or service without prior authorization from CRESTRON. To obtain warranty service for CRESTRON products, contact the factory and request an RMA (Return Merchandise Authorization) number. Enclose a note specifying the nature of the problem, name and phone number of contact person, RMA number, and return address.
2. Products may be returned for credit, exchange, or service with a CRESTRON Return Merchandise Authorization (RMA) number. Authorized returns must be shipped freight prepaid to CRESTRON, 6 Volvo Drive, Rockleigh, N.J., or its authorized subsidiaries, with RMA number clearly marked on the outside of all cartons. Shipments arriving freight collect or without an RMA number shall be subject to refusal. CRESTRON reserves the right in its sole and absolute discretion to charge a 15% restocking fee, plus shipping costs, on any products returned with an RMA.
3. Return freight charges following repair of items under warranty shall be paid by CRESTRON, shipping by standard ground carrier. In the event repairs are found to be non-warranty, return freight costs shall be paid by the purchaser.

CRESTRON Limited Warranty

CRESTRON ELECTRONICS, Inc. warrants its products to be free from manufacturing defects in materials and workmanship under normal use for a period of three (3) years from the date of purchase from CRESTRON, with the following exceptions: disk drives and any other moving or rotating mechanical parts, pan/tilt heads and power supplies are covered for a period of one (1) year; touchscreen display and overlay components are covered for 90 days; batteries and incandescent lamps are not covered.

This warranty extends to products purchased directly from CRESTRON or an authorized CRESTRON dealer. Purchasers should inquire of the dealer regarding the nature and extent of the dealer's warranty, if any.

CRESTRON shall not be liable to honor the terms of this warranty if the product has been used in any application other than that for which it was intended, or if it has been subjected to misuse, accidental damage, modification, or improper installation procedures. Furthermore, this warranty does not cover any product that has had the serial number altered, defaced, or removed.

This warranty shall be the sole and exclusive remedy to the original purchaser. In no event shall CRESTRON be liable for incidental or consequential damages of any kind (property or economic damages inclusive) arising from the sale or use of this equipment. CRESTRON is not liable for any claim made by a third party or made by the purchaser for a third party.

CRESTRON shall, at its option, repair or replace any product found defective, without charge for parts or labor. Repaired or replaced equipment and parts supplied under this warranty shall be covered only by the unexpired portion of the warranty.

Except as expressly set forth in this warranty, CRESTRON makes no other warranties, expressed or implied, nor authorizes any other party to offer any warranty, including any implied warranties of merchantability or fitness for a particular purpose. Any implied warranties that may be imposed by law are limited to the terms of this limited warranty. This warranty statement supercedes all previous warranties.

Trademark Information

All brand names, product names, and trademarks are the sole property of their respective owners. Windows is a registered trademark of Microsoft Corporation. Windows95/98/Me and WindowsNT/2000 are trademarks of Microsoft Corporation.

This page intentionally left blank.

This page intentionally left blank.



Crestron Electronics, Inc.
15 Volvo Drive Rockleigh, NJ 07647
Tel: 888.CRESTRON
Fax: 201.767.7576
www.crestron.com

Installation Guide - DOC. 6265
05.04

Specifications subject to
change without notice.