

# GLA-IS-D360-24 by Steinel

## Ceiling Mount Occupancy Sensor



Item No.	61136
Voltage	24 VDC, 19 mA
Mounting	ceiling mounts to standard MR16 fitting frame
Sensing Technology	passive infrared (PIR)
Time Delay Setting	5 seconds to 20 minutes
Light Level Setting	.2-200 footcandles 2-2000 lux
Environment	IP20 rated, -4°F to +122°F, -20°C to +50°C
Coverage	360° with 180° angle of aperture, up to 13 ft (4 m) radial reach, up to 26 ft (8 m) tangential reach
Sensors	3 dual element infrared pyroelectric detectors
Lens Design	720 switching zones, 10 detection levels
Dimensions (LxWxD)	3.23 x 2.01 in 82 x 51 mm
Warranty	5 years
Certifications	C-UL-US Listed, RoHS Compliant UL 2043 Plenum Rated CA Compliant

The IS D360-24 is a highly sensitive ceiling mount occupancy sensor for indoor use.

The sensor is passive infrared and responds to heat radiated from human body motion. They mount on a ceiling and turn lighting ON either automatically with occupancy or manually using a low voltage wall switch and the manual on mode of a STEINEL power pack. After a period of time where no occupancy has been detected, the sensor switches lighting OFF.

### Applications

Architecturally pleasing recessed ceiling mount for offices, conference rooms, vestibules, break rooms and a plenum areas.

### Key Features:

- 360° coverage with up to 13 ft (4 m) radial reach and 26 ft (8 m) tangential reach
- Snap-on shrouds allow users to easily customize the coverage area
- 3 pyroelectric detectors with 720 switching zones provides highly accurate small motion detection
- Automatically adjusts to temperature changes keeping sensitivity and coverage consistent
- Light level feature allows lighting to remain off during daylight regardless of occupancy



Voltage



Passive Infrared Technology



360° Coverage



IP20 Rated



Mounting

# GLA-IS-D360-24 by Steinel

## Ceiling Mount Occupancy Sensor



### Wiring

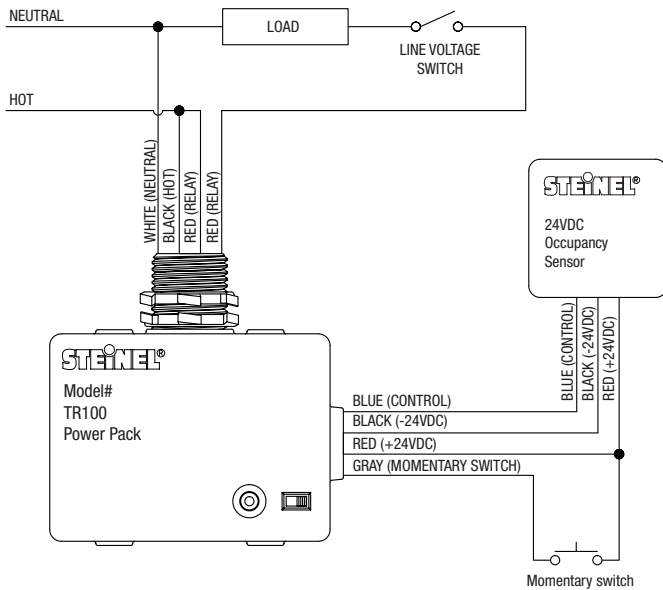

### Settings

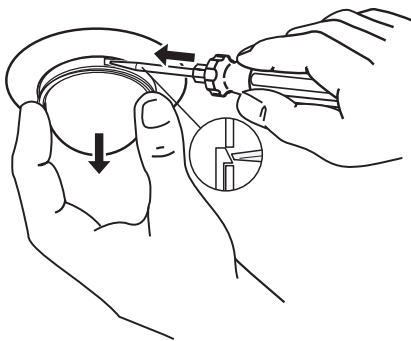

Light level and time delay settings are under the sensor module.

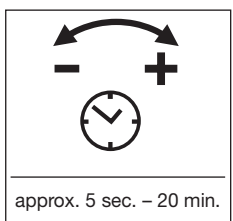
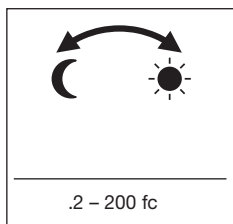

### Coverage

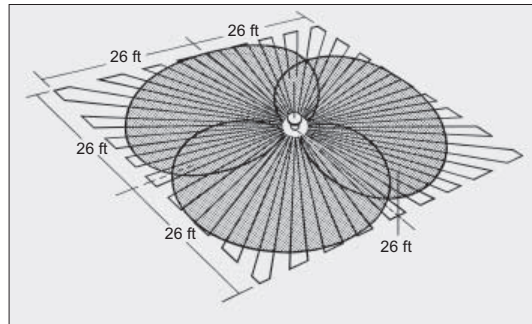

With a mounting height of 8 ft (2.5 m), the maximum reach of the sensor is 26 ft (8 m). Minor motion coverage, typical for an office environment, is 13 ft (4 m) radius. Coverage may vary depending on mounting height and environmental conditions.

### Coverage Adjustment

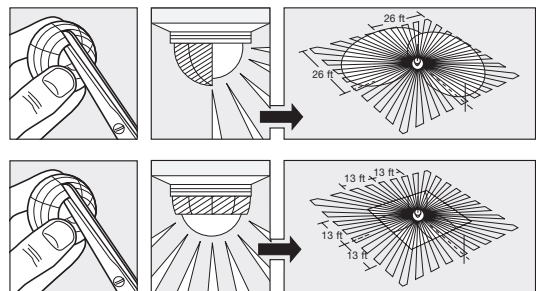

Shrouds, supplied with each unit, snap in place, allowing users to adjust coverage as needed.

### Mounting

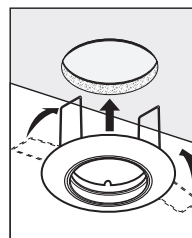

- 1 - Fitting frame
- 2 - Catch
- 3 - Switching module
- 4 - Sensor module
- 5 - Shroud
- 6 - Securing spring
- 7 - Light level setting
- 8 - Time delay setting

