

GLA-TR-200 and GLA-TR-250

STEINEL™ Super Duty Power Pack



GLA-TR-200

GLA-TR-250

- 20A normally closed latching relay for fail safe operations
- 20A plug load control
- Maintained or momentary switch input
- Communication link input
- Time delay
- Power up sequence ON, OFF, Last State
- Select either Manual ON or automatic ON operation via DIP switch
- LED status indicator
- Switching is performed at, or close to, the zero-cross of the AC waveform in order to improve relay performance
- 1/2 in. threaded nipple and two lock nuts are used to secure to a standard 1/2 in. knockout
- Low voltage maintained or momentary switch input allows for manual control
- Power supply provides up to 270mA of 24VDC to low voltage controls

The GLA-TR-200 and GLA-TR-250 are full-featured, super duty lighting and plug load power packs that provide power to low voltage occupancy sensors and other control devices. The power packs switch the load(s) on and off in response to signals from control inputs.

The GLA-TR-250 contains force on and force off inputs for use with a building management system. The isolated normally open and normally closed relay is used for signaling a BMS, HVAC controls, or other low voltage devices.

The GLA-TR-200 and GLA-TR-250 are Class 2 Output Power Supplies, suitable for parallel interconnection.

Specifications

Power Requirements

Voltage	120/230/277VAC, 50/60Hz
Output	24VDC +/- 5% 270mA (class 2)
Load	20A Ballast/ELV/MLV/Tungsten/LED 16A E-Ballast/CFL 1 hp @ 120-240VAC, 50/60Hz 20A, 120VAC Plug load - receptacle

Isolated Relay (GLA-TR-250 only)

Single pole, double-throw with NO, NC and common contacts; rated A @ 30VAC/VDC

Wires

Line voltage wires	(1) Black, 18 AWG, Line (1) White 18 AWG, Neutral (2) Red 12 AWG, Normally Closed dry contact from the 20A relay
---------------------------	--

Low-voltage conductors	(1) Red 22 AWG, +24VDC (1) Black 22 AWG, -24VDC (1) Blue, 22 AWG, Control Input (1) Brown 22 AWG, Communication Link (1) Gray 22 AWG, Switch Input
-------------------------------	--

Additional wires on the GLA-TR-250:

- (1) Orange, 22 AWG, Override On
- (1) Brown/Orange, 22 AWG, Force Off

Isolated relay contacts:

- (1) Yellow/Red, 22 AWG, Normally Open
- (1) Yellow, 22 AWG, Relay Common
- (1) Yellow/Black, 22 AWG, Normally Closed

Environmental

Temperature	-4° to +130°F (-20° to +55°C) Rated IP20
--------------------	---

Mounting

1/2 in. threaded nipple and two lock nuts are used to secure to a standard 1/2 in. knockout

Dimensions

Height	3.80 in. (96 mm)
Width	2.96 in. (75 mm)
Depth	1.52 in. (38 mm)

Compliance

UL® Listed 2043 Plenum Rated

GLA-TR-200 and GLA-TR-250

STEINEL™ Super Duty Power Pack

Models

GLA-TR-200

STEINEL™ Super Duty Power Pack

GLA-TR-250

STEINEL™ Super Duty Power Pack with Isolated Relay

This product may be purchased from select authorized Crestron dealers and distributors. To find a dealer or distributor, please contact the Crestron sales representative for your area. A list of sales representatives is available online at www.crestron.com/How-To-Buy/Find-a-Representative or by calling 855-263-8754.

This product is covered under the Crestron standard limited warranty. Refer to www.crestron.com/warranty for full details.

The specific patents that cover Crestron products are listed online at patents.crestron.com.

Certain Crestron products contain open source software. For specific information, please visit www.crestron.com/opensource.

Crestron and the Crestron logo are either trademarks or registered trademarks of Crestron Electronics, Inc. in the United States and/or other countries. STEINEL and the STEINEL logo are either trademarks or registered trademarks of Steinel Vertrieb GmbH in the United States and/or other countries. UL and the UL logo are either trademarks or registered trademarks of Underwriters Laboratories, Inc. in the United States and/or other countries. Other trademarks, registered trademarks, and trade names may be used in this document to refer to either the entities claiming the marks and names or their products. Crestron disclaims any proprietary interest in the marks and names of others. Crestron is not responsible for errors in typography or photography.

Specifications are subject to change without notice.

©2020 Crestron Electronics, Inc.

Rev 11/20/20

GLA-TR-200 and GLA-TR-250

STEINEL™ Super Duty Power Pack

Mounting

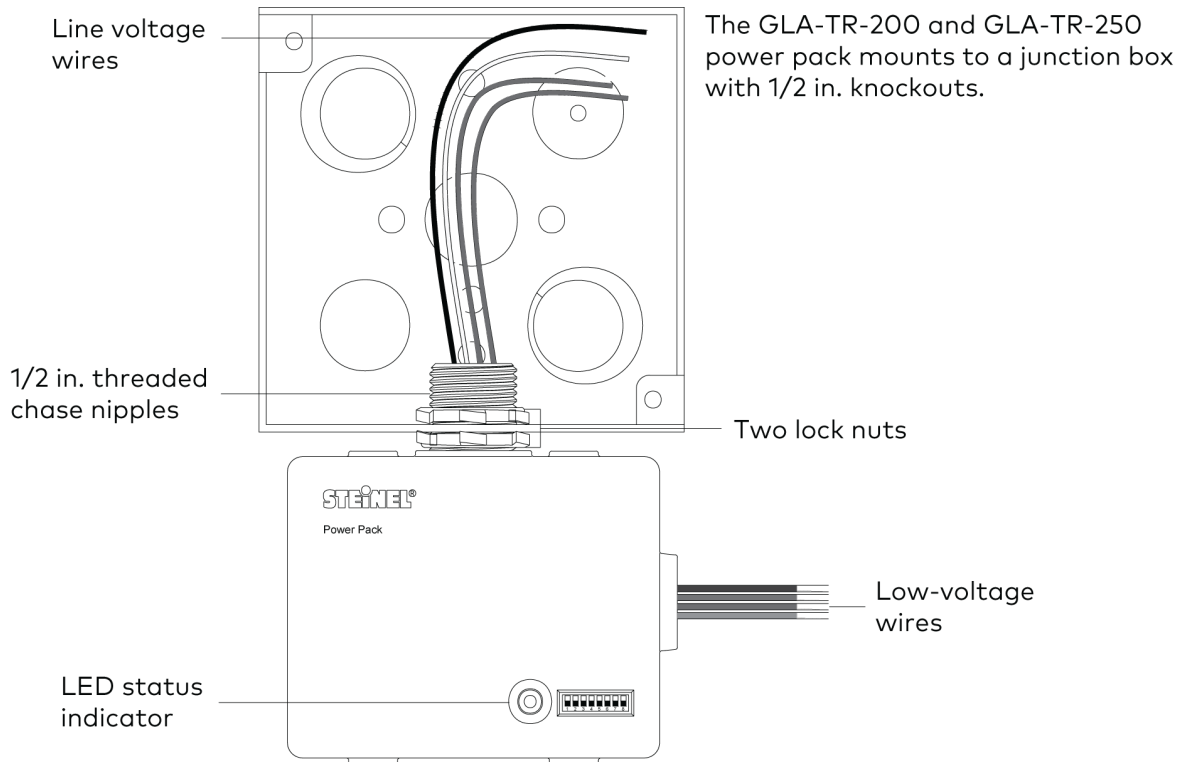

GLA-TR-200 and GLA-TR-250

STEINEL™ Super Duty Power Pack

GLA-TR-200 Low-Voltage Three-Way Wiring

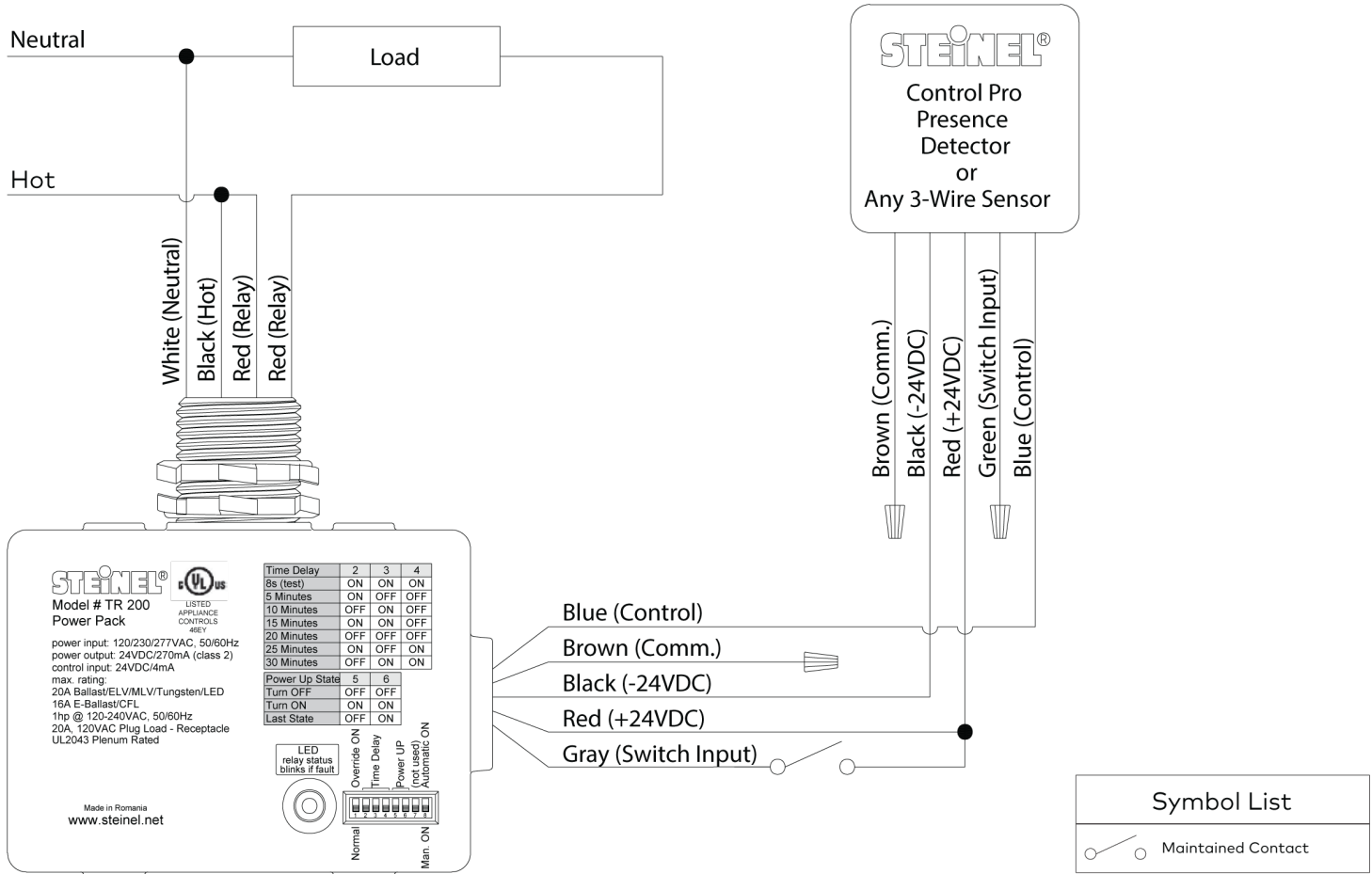

GLA-TR-200 and GLA-TR-250

STEINEL™ Super Duty Power Pack

GLA-TR-200 and GLA-TR-250 Manual On Lighting Load and Automatic On Plug Load (GLA-TR-200 shown)

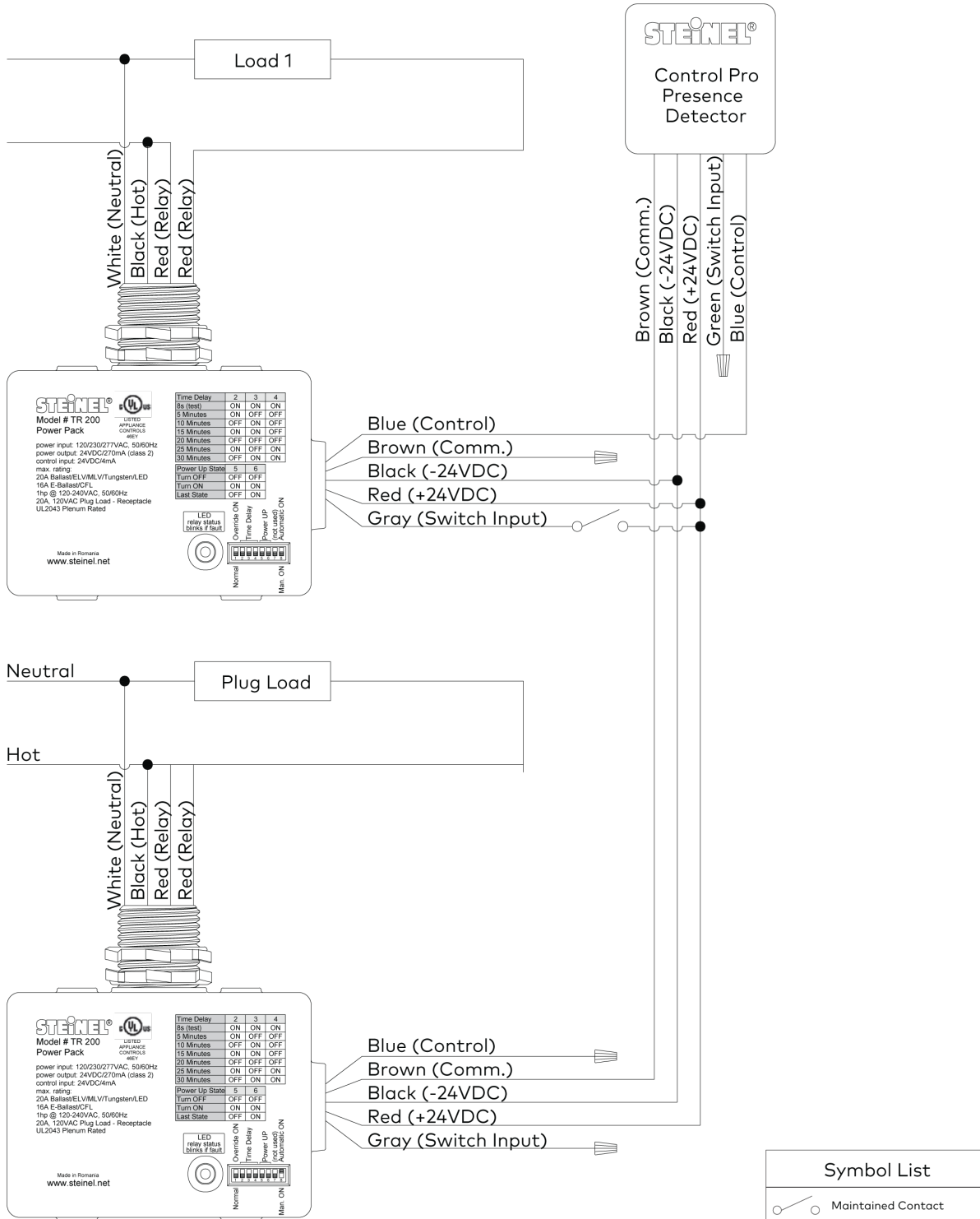

GLA-TR-200 and GLA-TR-250

STEINEL™ Super Duty Power Pack

GLA-TR-250 Typical Wiring with a 24V Sensor

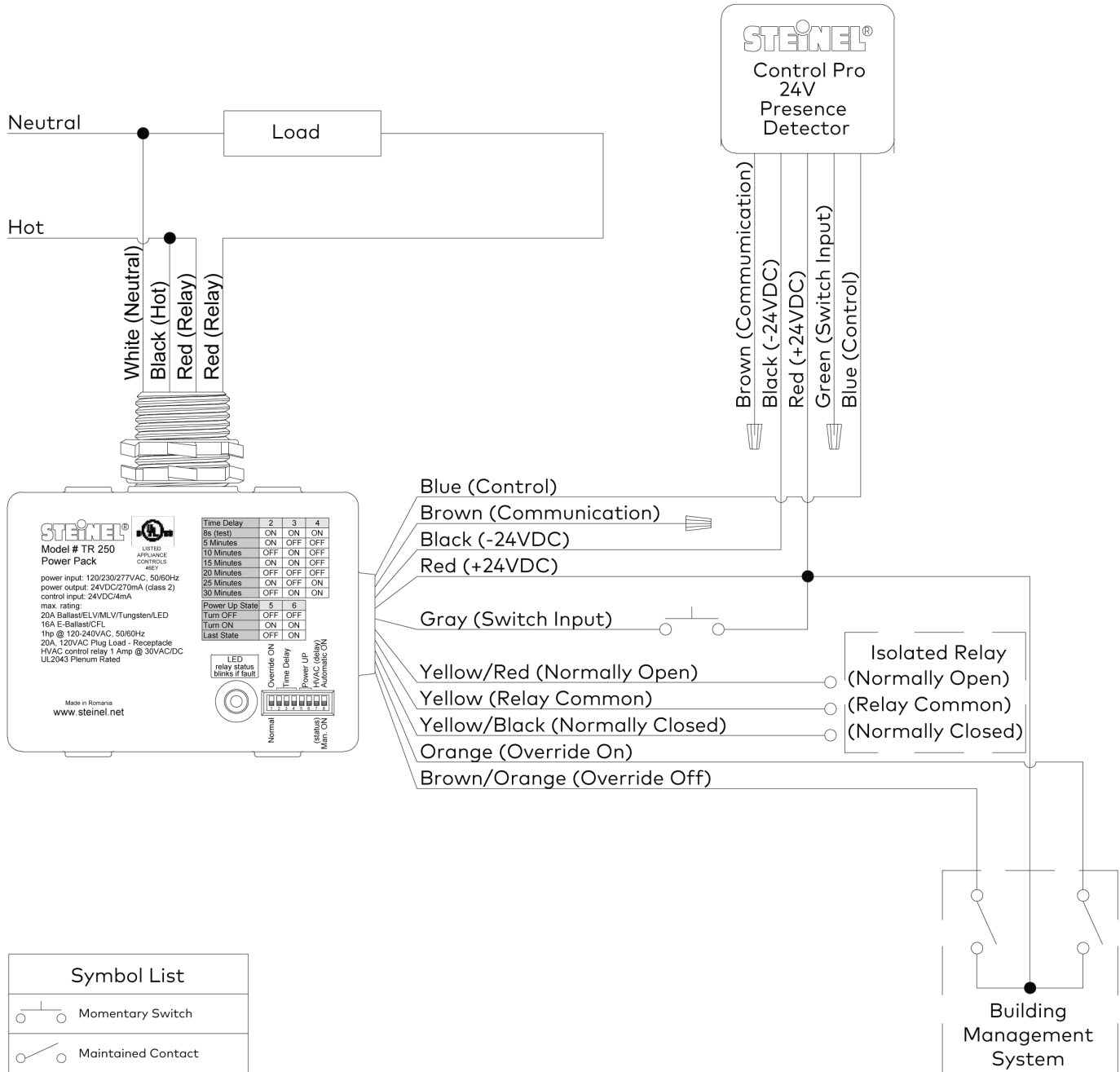

GLA-TR-200 and GLA-TR-250

STEINEL™ Super Duty Power Pack

GLA-TR-250 Low-Voltage Three-Way Wiring

