



Further Inquiries

If you cannot locate specific information or have questions after reviewing this guide, please take advantage of Crestron's award winning customer service team by calling Crestron at 1-888-CRESTRON [1-888-273-7876].

You can also log onto the online help section of the Crestron website (www.crestron.com/onlinehelp) to ask questions about Crestron products. First-time users will need to establish a user account to fully benefit from all available features.

Future Updates

As Crestron improves functions, adds new features and extends the capabilities of the CLW-SLV-P units, additional information may be made available as manual updates. These updates are solely electronic and serve as intermediary supplements prior to the release of a complete technical documentation revision.

Check the Crestron website periodically for manual update availability and its relevance. Updates are identified as an "Addendum" in the Download column.

WARNINGS, CAUTIONS & NOTES

WARNING: To avoid fire, shock, or death; turn off power at circuit breaker or fuse and test that power is off before wiring!

NOTES: Observe the following points.

- To be installed and/or used in accordance with appropriate electrical codes and regulations.
- If you are unsure about any part of these instructions, consult a qualified electrician.
- Sensors must be mounted on a vibration free surface.

PREPARING AND CONNECTING WIRES

Strip the ends of the wires approximately 1/2 inch (13 mm). Use care to avoid nicking the conductors. Twist together the ends of the wires that share a connection and tin the twisted connection. Apply solder only to the ends of the twisted wires. Avoid tinning too far up the wires or the end becomes brittle. The label on the rear of the device contains a gauge for wire stripping

Crestron Electronics, Inc.
15 Volvo Drive Rockleigh, NJ 07647
Tel: 888.CRESTRON
Fax: 201.767.7576
www.crestron.com

Installation Guide - DOC. 6826B
(2024297)
03.11

Specifications subject to change without notice.

Regulatory Compliance

This product is Listed to applicable UL Standards and requirements by Underwriters Laboratories Inc.



Federal Communications Commission (FCC) Compliance Statement

This device complies with Part 15 of the FCC Rules. Operation is subject to the following two conditions: (1) This device may not cause harmful interference, and (2) This device must accept any interference received, including interference that may cause undesired operation.

CAUTION: Changes or modifications not expressly approved by the manufacturer responsible for compliance could void the user's authority to operate the equipment.

NOTE: This equipment has been tested and found to comply with the limits for a Class B digital device, pursuant to part 15 of the FCC Rules. These limits are designed to provide reasonable protection against harmful interference in a residential installation. This equipment generates, uses and can radiate radio frequency energy and if not installed and used in accordance with the instructions, may cause harmful interference to radio communications. However, there is no guarantee that interference will not occur in a particular installation. If this equipment does cause harmful interference to radio or television reception, which can be determined by turning the equipment off and on, the user is encouraged to try to correct the interference by one or more of the following measures:

- Reorient or relocate the receiving antenna
- Increase separation between the equipment and the receiver
- Connect the equipment into an outlet on a circuit different from that to which the receiver is connected
- Consult the dealer or an experienced radio/TV technician for help

Industry Canada (IC) Compliance Statement

This Class B digital apparatus complies with Canadian ICES-003.
Cet appareil numérique de la classe B est conforme à la norme NMB-003 du Canada.

DESCRIPTION

The CLW-SLV-P is a wall mount slave dimmer/switch designed for use with Cameo® dimmers and switches. Multipoint dimming is enabled using Cameo Professional Dimmers or Switches and up to six slave dimmers each. Multipoint dimming is similar to conventional 3-way or 4-way switching, allowing dimming control of a single load from multiple locations in the room.

NOTE: The CLW-SLV-P cannot be used to control a load directly, but must be used in conjunction with a CLW-SWEX-P, CLW-DIMEX-P, CLW-SWCN-P, or CLW-DIMCN-P.

Specifications

Specifications for the CLW-SLV-P are listed in the following table.

CLW-SLV-P Specifications

SPECIFICATION	DETAILS
Power Requirements	120 VAC, 60 Hz
Operating Temperature and Humidity	32°F to 104°F (0°C to 40°C) 10 to 90% Relative Humidity (Non-Condensing)
Dimensions and Weight	
Height	4 1/8 in (105 mm)
Width	1 3/4 in (45 mm)
Depth	1 3/4 in (45 mm)
Weight	4 oz (118 g)
Max Wire Length Between CLW-DIM / CLW-SW and Furthest CLW-SLV.	250 ft (77 m)

NOTE: Crestron® software and any files on the website are for authorized Crestron dealers and Crestron Authorized Independent Programmers (CAIP) only. New users may be required to register to obtain access to certain areas of the site (including the FTP site).

Important Notes

Read before installation.

- Codes: Install in accordance with all local and national electrical codes.

CAUTION: TO REDUCE THE RISK OF OVERHEATING AND POSSIBLE DAMAGE TO OTHER EQUIPMENT, DO NOT INSTALL TO CONTROL A RECEPTACLE OR A TRANSFORMER-SUPPLIED APPLIANCE.
ATTENTION: GRADATEURS COMMANDANT UN BALLAST-AFIN DE REDUIRE LE RISQUE DE SURCHAUFFE ET LA POSSIBILITE D'ENDOMMAGEMENT A D'AUTRES MATERIELS, NE PAS INSTALLER POUR COMMANDER UNE PRISE OU UN APPAREIL ALIMENTE PAR UN TRANSFORMATEUR.

NOTE: The CLW-SLV-P cannot be used to control a load directly, but must be used in conjunction with a CLW-SWEX-P, CLW-DIMEX-P, CLW-SWCN-P, or CLWDIMCN-P.

NOTE: All 3- or 4-way switches in a multi-way circuit must be replaced by CLW-SLV-P units with a single CLW-DIM or CLW-SW unit installed at the load side of the multi-way chain.

- Wiring: Use copper wire only. For supply connections, use wires rated for at least 75°C.
- Temperature: For use where temperatures are between 32° to 104°F (0° to 40°C).
- Electrical Boxes: Devices mount in standard electrical boxes. For easy installation, Crestron recommends using 3 1/2" deep electrical boxes. Several devices can be installed in one electrical box (multigang). For a smooth appearance, one-piece multigang faceplates (not supplied) can be installed.
- When installing into a multigang box, do not fully tighten devices to box until faceplate has been aligned.
- Spacing: If mounting one device above another, leave at least 4 1/2" vertical space between them.
- Neutral connection required for CLW-SLV-P LED to function.
- Neutral connection required if master device (CLW-DIM or CLW-SW) is connected to neutral.

INSTALLATION

WARNING: Turn off power at the circuit breaker. Installing with power on can result in serious personal injury and damage to the device.

The following describes the installation of a CLW-SLV-P dimmer.

- Turn power off at the circuit breaker.
- The diagrams to the right illustrate typical wiring configurations for the CLW-SLV-P. Select the appropriate configuration and connect the necessary wires.

NOTE: Refer to the following diagram when making connections to the device.

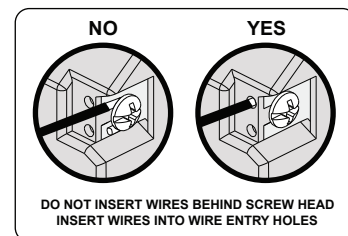

- Push all power wires back into the electrical box and fasten the device to the electrical box with the provided screws.
- Attach decorative faceplate.
- Ensure buttons actuate without sticking.
- Restore power at the circuit breaker.

WIRING DIAGRAMS

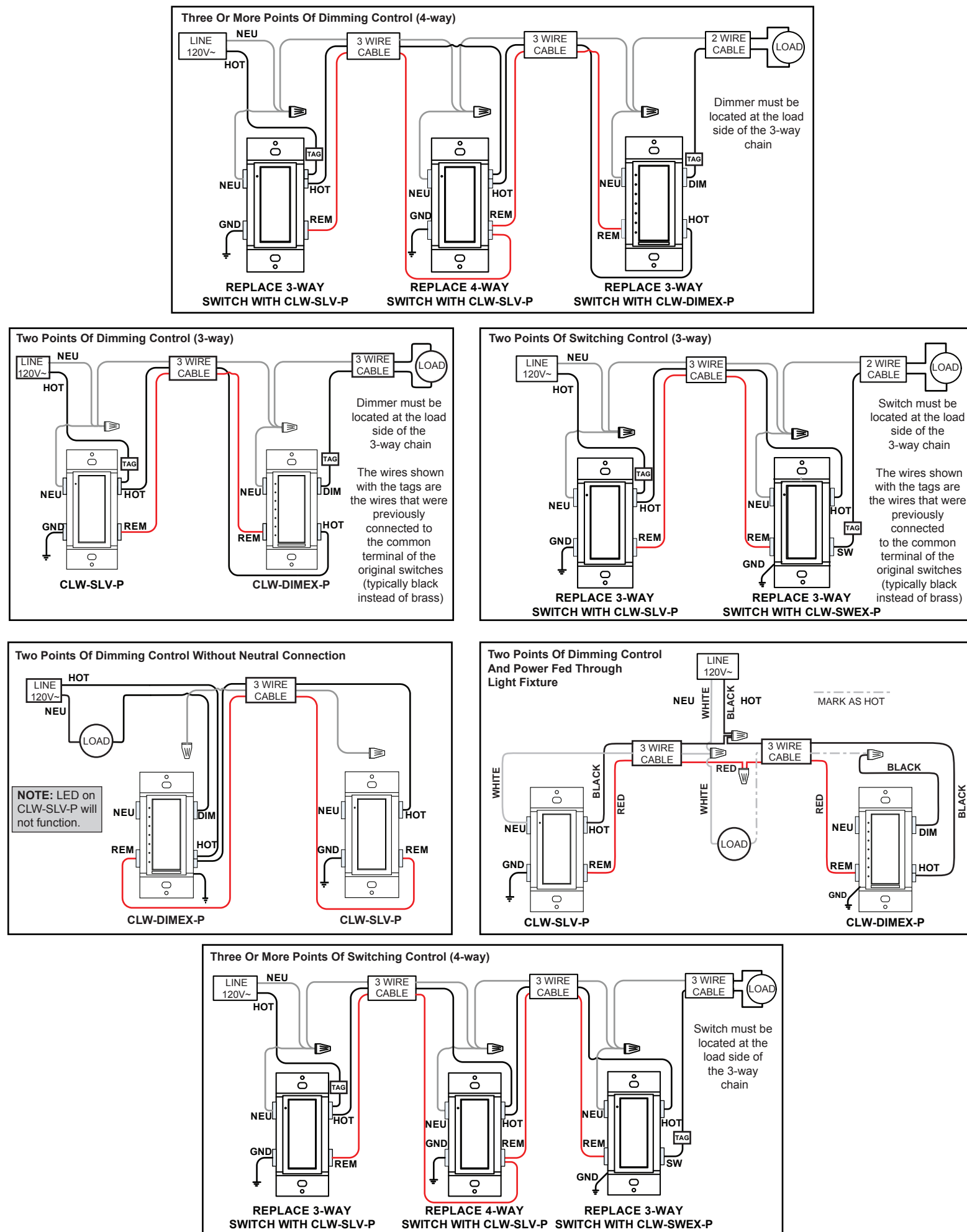

Changing Button Assemblies

The button assembly can be removed and replaced with other button assemblies. To change the button assembly:

- As shown in the following diagram, remove the button assembly by squeezing the sides of the bezel near the bezel snaps.

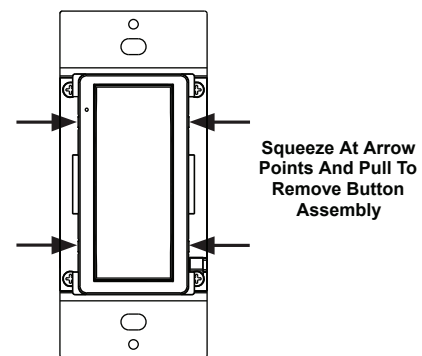

- Remove button(s) from the front of the button assembly as shown in the following diagram.

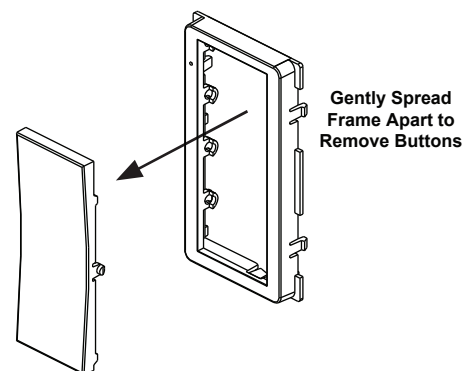

- Insert new buttons through the front of the bezel and snap into place as shown in the following diagram. Ensure that the LED strip is on the left side.

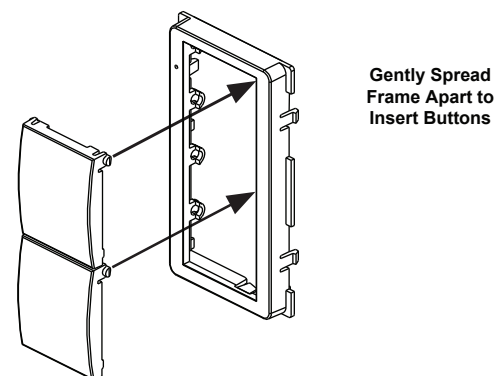

- Attach button assembly to the device as shown in the following diagram. Ensure that LED strip is on the left side.

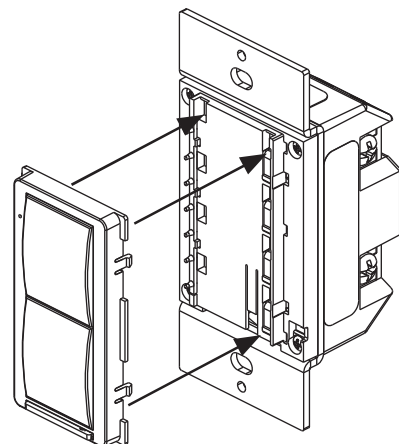

OPERATION

NOTE: The device may be warm to the touch during operation. This is normal.

Basic Operation

The CLW-SLV-P is shipped with a rocker switch already installed. In this configuration, the unit will function as shown below.

The specific functions of the slave device depend on the master device at the other end. If the master is a CLW-DIMEX, then the button function is the same as a CLW-DIMEX-P with a rocker; if a switch is installed, the slave function is the same as a switch with a rocker button.

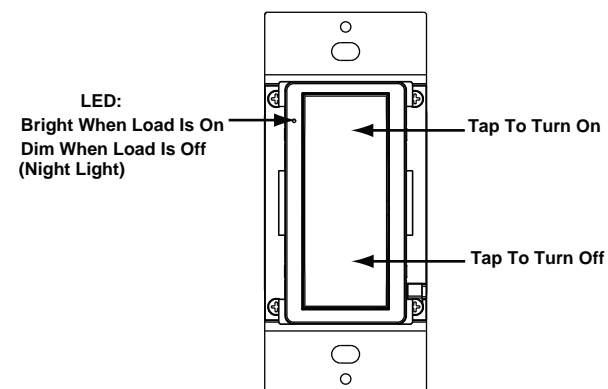

Default Button Functions

The figures below illustrate the default functions available for each physical button configuration and tap/hold actuation sequence.

Button TAP

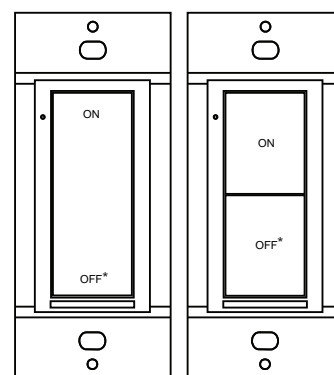

Button DOUBLE TAP

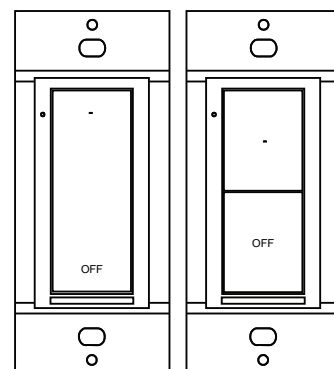

* Delay can be added via control system programming.

TROUBLESHOOTING

The table after this paragraph provides corrective action for possible trouble situations. This troubleshooting applies to multi-way installations where one or more slave device (CLW-SLV-P) is connected to a master (CLW-DIMEX-P, CLW-DIMCN-P, CLW-SWEX-P or CLW-SWCN-P). If further assistance is required, please contact a Crestron customer service representative.

TROUBLE	POSSIBLE CAUSE (S)	CORRECTIVE ACTION
Master dimmer or switch does not function when buttons pressed on master or slave.	Problem with dimmer / switch installation.	Refer to "Troubleshooting" section in dimmer/switch installation guide.
	Existing 3/4-way switch still connected.	Replace all 3/4-way switches with CLW-SLV. Replace 3-way switch connected to load with CLW-DIM or CLW-SW.
Master dimmer or switch works but neither button on slave works.	Wiring issue.	Check connections on all slave units and on master dimmer / switch.
	Wiring issue at master dimmer, DIM and HOT reversed.	Check connections at master dimmer.
	Existing 3/4-way switch still connected.	Replace all 3/4-way switches with CLW-SLV. Replace 3-way switch connected to load with CLW-DIM or CLW-SW.
Master dimmer or switch works but only the bottom button on slave works.	Master dimmer / slave is not connected at the load side of the multi-way circuit.	Ensure master dimmer / switch is connected at the Load side of the multi-way chain, i.e. DIM or SW connects directly to the lighting fixture.
Master dimmer or switch works but only the top button on slave works.	No neutral connection at slave.	Connect neutral to slave.
Pressing buttons on slave makes master dimmer or switch perform the wrong action.	Wiring at slave is incorrect, HOT and REM swapped.	Ensure that HOT, NEU and REM on slave are connected correctly.
Slave LED does not function, i.e. stays Off.	No neutral connection at slave.	Connect neutral to slave.

NOTE: Model Number for Master Dimmer: CLW-DIMEX-P infinet EX Dimmer
 CLW-DIMCN-P Cresnet Dimmer
 Model Number for Master Switch: CLW-SWEX-P infinet EX Switch
 CLW-SWCN-P Cresnet Switch

Return and Warranty Policies

Merchandise Returns / Repair Service

- No merchandise may be returned for credit, exchange or service without prior authorization from CRESTRON. To obtain warranty service for CRESTRON products, contact an authorized CRESTRON dealer. Only authorized CRESTRON dealers may contact the factory and request an RMA (Return Merchandise Authorization) number. Enclose a note specifying the nature of the problem, name and phone number of contact person, RMA number and return address.
- Products may be returned for credit, exchange or service with a CRESTRON Return Merchandise Authorization (RMA) number. Authorized returns must be shipped freight prepaid to CRESTRON, 6 Volvo Drive, Rockleigh, N.J. or its authorized subsidiaries, with RMA number clearly marked on the outside of all cartons. Shipments arriving freight collect or without an RMA number shall be subject to refusal. CRESTRON reserves the right in its sole and absolute discretion to charge a 15% restocking fee plus shipping costs on any products returned with an RMA.
- Return freight charges following repair of items under warranty shall be paid by CRESTRON, shipping by standard ground carrier. In the event repairs are found to be non-warranty, return freight costs shall be paid by the purchaser.

CRESTRON Limited Warranty

CRESTRON ELECTRONICS, Inc. warrants its products to be free from manufacturing defects in materials and workmanship under normal use for a period of three (3) years from the date of purchase from CRESTRON, with the following exceptions: disk drives and any other moving or rotating mechanical parts, pan/tilt heads and power supplies are covered for a period of one (1) year; touchscreen display and overlay components are covered for 90 days; batteries and incandescent lamps are not covered.

This warranty extends to products purchased directly from CRESTRON or an authorized CRESTRON dealer. Purchasers should inquire of the dealer regarding the nature and extent of the dealer's warranty, if any. CRESTRON shall not be liable to honor the terms of this warranty if the product has been used in any application other than that for which it was intended or if it has been subjected to misuse, accidental damage, modification or improper installation procedures. Furthermore, this warranty does not cover any product that has had the serial number altered, defaced or removed.

This warranty shall be the sole and exclusive remedy to the original purchaser. In no event shall CRESTRON be liable for incidental or consequential damages of any kind (property or economic damages inclusive) arising from the sale or use of this equipment. CRESTRON is not liable for any claim made by a third party or made by the purchaser for a third party.

CRESTRON shall, at its option, repair or replace any product found defective, without charge for parts or labor. Repaired or replaced equipment and parts supplied under this warranty shall be covered only by the unexpired portion of the warranty. Except as expressly set forth in this warranty, CRESTRON makes no other warranties, expressed or implied, nor authorizes any other party to offer any warranty, including any implied warranties of merchantability or fitness for a particular purpose. Any implied warranties that may be imposed by law are limited to the terms of this limited warranty. This warranty statement supersedes all previous warranties.