

## Reference 4 in. 2-Way Outdoor Speaker, Bronze Textured, Single

The Crestron® Reference Speaker [REFERENCE OD4-BRZ-T-EACH](#) made by Origin Acoustics delivers the pinnacle of performance for demanding residential installations. Select materials, top shelf components and a high-end appearance underscore the design behind each speaker. The result is a no-compromise outdoor speaker designed to be staked directly into the ground or mounted to an exterior wall, fence post, or tree.



## Installation

### Prepare the Site

The Crestron Reference speaker [REFERENCE OD4-BRZ-T-EACH](#) can be installed at ground level using the supplied stake. It can also be mounted to outdoor hard surfaces, such as a trellis, under an eave, on a wall, on a deck, or to a post using the surface/tree mount [SPKA-SMK/TREEMK-REFERENCE-OD4](#) (optional).

- For in-ground level installation, choose a location that will not flood and where the speaker will not be affected by an in-ground sprinkler system.
- For above-ground installation, the speaker is mounted with either the surface or tree mounting bracket (not included).



### In the Box

1 REFERENCE OD4-BRZ-T-EACH

#### Additional Items

1 Ground stake

2 Wire nuts

## Reference 4 in. 2-Way Outdoor Speaker, Bronze Textured, Single

## Mount the Speaker

## In-Ground Installation

For in-ground installation:

1. Pull the speaker cable through the top of the stake and out either side on the bottom opening.
2. Drive the ground stake (included) into the ground.
  - For installation in soft soil: The stake can be installed without excavating the soil. Push the stake down into the soil.
  - For installation in hard soil: Dig a hole for the stake. Place the stake in the hole with the top cylinder of the stake above ground level. Hold the stake straight while backfilling and compacting the soil.
3. Attach the speaker to the stake by turning the speaker clockwise until it is mounted properly.

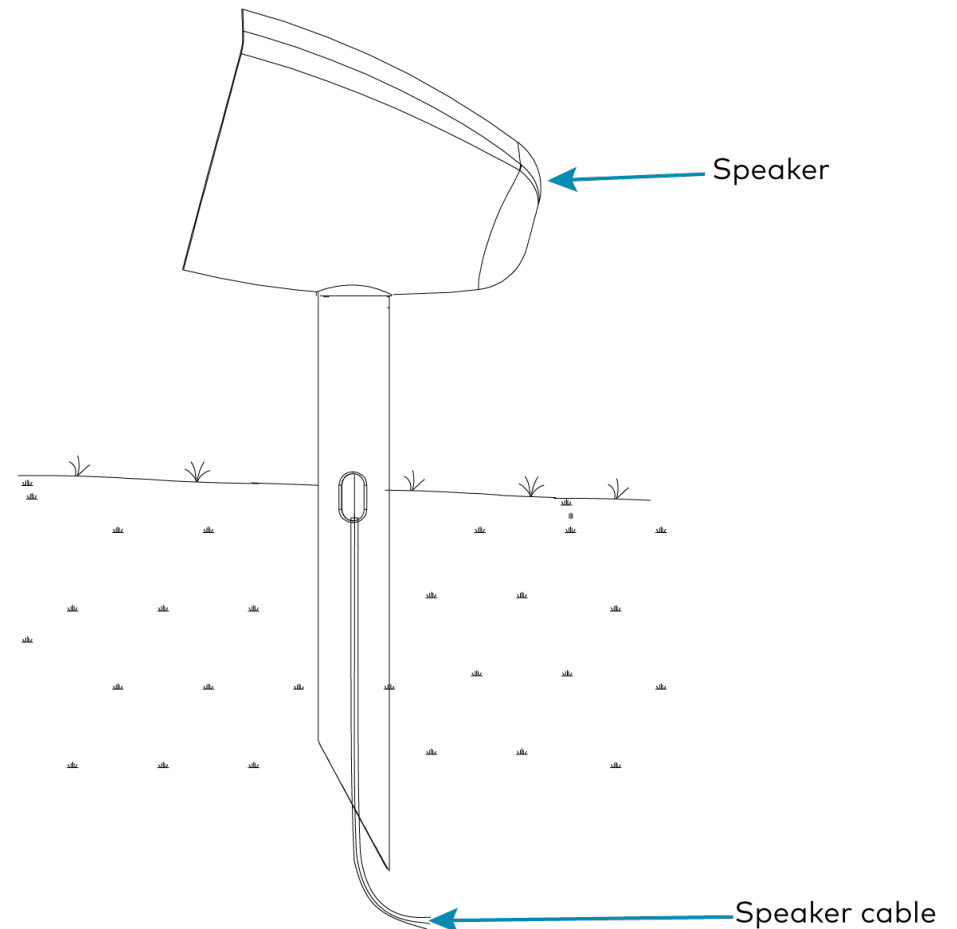

## Reference 4 in. 2-Way Outdoor Speaker, Bronze Textured, Single

### Above-Ground Installation

Use the [SPKA-SMK/TREEMK-REFERENCE-OD4](#) optional accessory to install the speakers on a surface or a tree. This accessory must be purchased separately.

For surface mount installation:

1. Route the speaker cable through all the components of the knuckle adapter bracket.
2. Install the knuckle adapter bracket (not included) to the speaker as shown in figure A.

**NOTE:** The knuckle adapter bracket comprises nut 1, mount base, mount adapter, and nut 2.

- a. Turn nut 1 clockwise until it is secured to the speaker.
  - b. Fit the mount base onto the threaded end of the speaker, and rotate it clockwise until it is secured.
  - c. Attach the mount adapter to the mount base using the Allen screw.
  - d. Tighten nut 2 over the threaded end of the mount adapter.
3. Select a suitable location to mount the surface mount bracket.
  4. Install the surface mount bracket as follows:
    - a. Place the surface mount bracket (not included) in the mounting location.
    - b. Hold the surface mount bracket against the surface to mark the screw holes.
    - c. Drill holes at the marked screw hole locations and install three anchors (not included).
    - d. Route the speaker cable through the center hole and out of the cable opening on the surface mount bracket.
    - e. Secure the surface mount bracket to the surface using drywall screws (not included).

5. Attach the speaker to the surface mount bracket by hand threading the assembled speaker to the surface mount bracket.
6. For optimal sound coverage, adjust the speaker left or right and up or down.
  - a. Adjust the speaker left or right by adjusting the mounting base threads and nut 2.
  - b. Adjust the speaker up or down by first loosening the allen screw on the mount base. Adjust the angle to the desired position, then retighten the screw.

Figure A

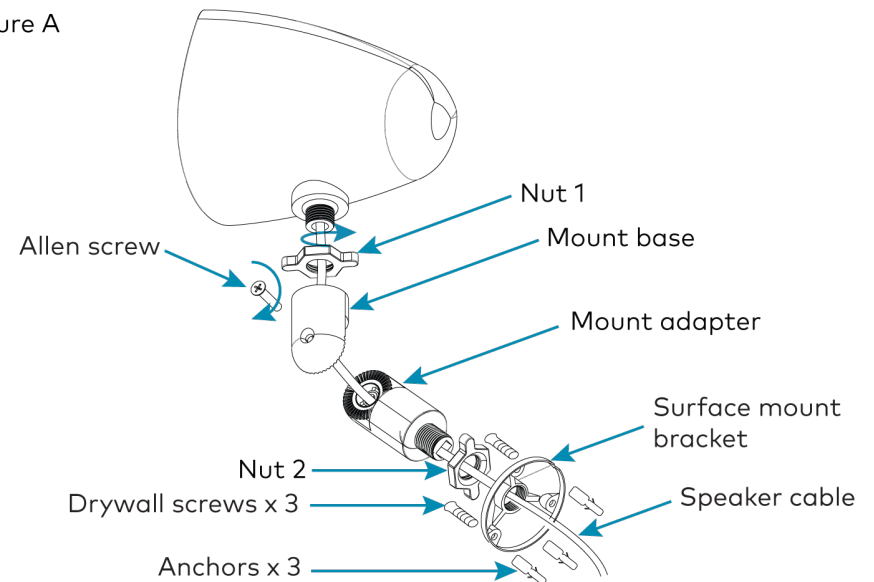

## Reference 4 in. 2-Way Outdoor Speaker, Bronze Textured, Single

For tree mount installation:

1. Route the speaker cable through all the components of the knuckle adapter bracket.
2. Install the knuckle adapter bracket (not included) to the speaker as shown in figure B.

**NOTE:** The knuckle adapter bracket comprises nut 1, mount base, mount adapter, and nut 2.

- a. Turn nut 1 clockwise until it is secured to the speaker.
  - b. Fit the mount base onto the threaded end of the speaker, and rotate it clockwise until it is secured.
  - c. Attach the mount adapter to the mount base using the Allen screw.
  - d. Tighten nut 2 over the threaded end of the mount adapter.
3. Install the tree mount bracket as follows:
    - a. Place the tree mount bracket (not included) in the mounting location.
    - b. Hold the tree mount bracket against the surface to mark the screw holes.
    - c. Drill holes at the marked screw hole locations and install three anchors (not included).
    - d. Route the speaker cable through the center hole and out of the cable opening on the tree mount bracket.
    - e. Secure the tree mount bracket (not included) to a tree using drywall screws (not included).
  4. Attach the speaker to the tree mount bracket by hand threading the assembled speaker to the tree mount bracket.

5. For optimal sound coverage, adjust the speaker left or right and up or down.
  - a. Adjust the speaker left or right by adjusting the mounting base threads and nut 2.
  - b. Adjust the speaker up or down by first loosening the allen screw on the mount base. Adjust the angle to the desired position, then retighten the screw.

Figure B

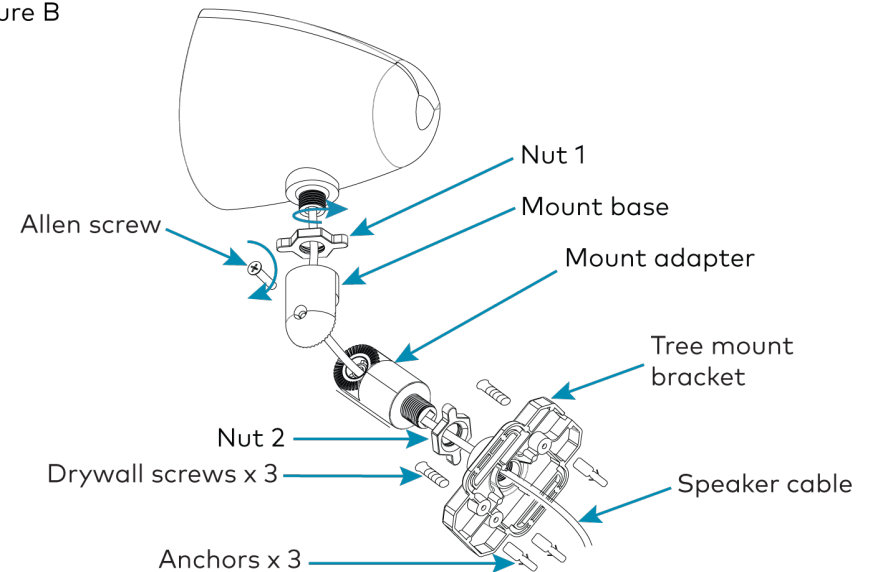

## REFERENCE OD4-BRZ-T-EACH

### Reference 4 in. 2-Way Outdoor Speaker, Bronze Textured, Single

#### Connect the Speaker Cable

1. Run the speaker cable (not included) from the audio source to the wire nut, observing all appropriate local codes.
2. Run the speaker cable from the speaker location to the wire nut, observing all appropriate local codes.

#### NOTES:

- The speaker includes a hardwired direct-burial speaker cable.
  - Make sure that the positive cable is attached to the red connection, and the negative cable is attached to the black connection.
  - Each [REFERENCE OD4-BRZ-T-EACH](#) speaker presents a 16 ohm load to the amplifier, and is designed to be wired in parallel either with additional [REFERENCE OD4-BRZ-T-EACH](#) speakers and/or with the subwoofer included in the [REFERENCE OD4.1-4-S10-BRZ-T KIT](#). These speakers are also suitable replacements for the speakers in the [REFERENCE OD4.1-4-S10-BRZ-T KIT](#).
3. Combine and twist the positive (+) cables together in a clockwise motion. Repeat this step for the negative (-) cables.
  4. Secure the two cables together using the wire nuts ensuring that NO COPPER is exposed.

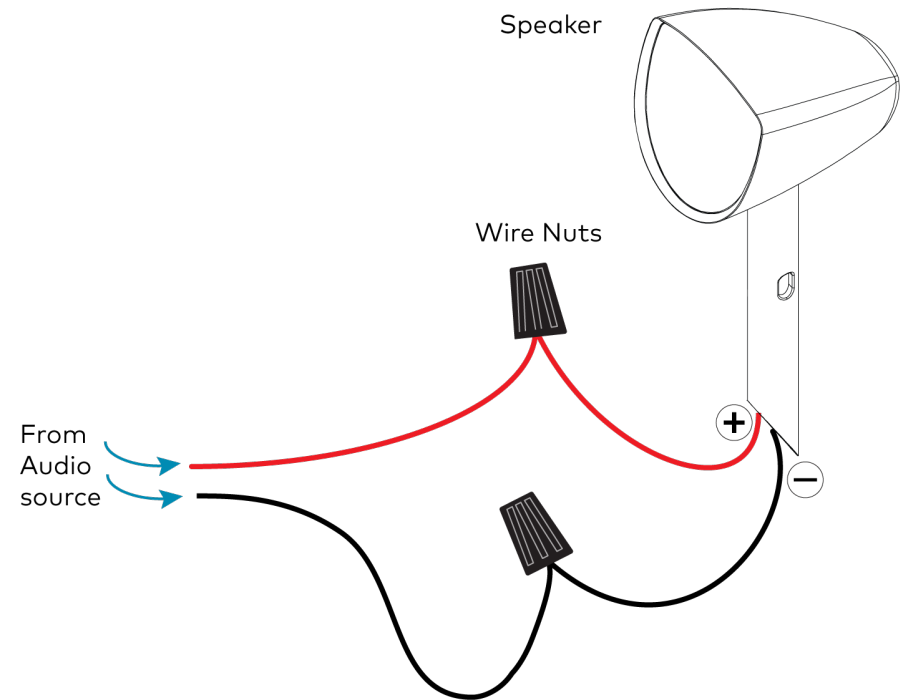

## Reference 4 in. 2-Way Outdoor Speaker, Bronze Textured, Single



## Visit the Product Page

Scan the QR code to visit the product page.

REFERENCE OD4-BRZ-T-EACH



<https://www.crestron.com/model/6511866>

## Additional Information

**Original Instructions**

The U.S. English version of this document is the original instructions. All other languages are a translation of the original instructions.

Crestron product development software is licensed to Crestron dealers and Crestron Service Providers (CSPs) under a limited nonexclusive, nontransferable Software Development Tools License Agreement. Crestron product operating system software is licensed to Crestron dealers, CSPs, and end-users under a separate End-User License Agreement. Both of these Agreements can be found on the Crestron website at [www.crestron.com/legal/software\\_license\\_agreement](http://www.crestron.com/legal/software_license_agreement).

The product warranty can be found at [www.crestron.com/warranty](http://www.crestron.com/warranty).

The specific patents that cover Crestron products are listed at [www.crestron.com/legal/patents](http://www.crestron.com/legal/patents).

Certain Crestron products contain open source software. For specific information, visit [www.crestron.com/opensource](http://www.crestron.com/opensource).

Crestron and the Crestron logo are either trademarks or registered trademarks of Crestron Electronics, Inc. in the United States and/or other countries. Origin Acoustics is either a trademark or registered trademark of Origin Acoustics, Inc. in the United States and/or other countries. Other trademarks, registered trademarks, and trade names may be used in this document to refer to either the entities claiming the marks and names or their products. Crestron disclaims any proprietary interest in the marks and names of others. Crestron is not responsible for errors in typography or photography.

©2021 Crestron Electronics, Inc.

Doc. 9033B

09/09/21