

# HD-RX3-C

## 4K HDMI® over HDBaseT® Receiver

### 1 Introduction

The Crestron® HD-RX3-C connects directly to an HDBaseT® compliant source, enabling the transmission of high-definition digital video and audio signals up to 330 feet (100 meters) over a single CAT5e cable. When used with the HD-TX3-C transmitter, the HD-RX3-C transmits HDMI® signals as well as RS-232 and IR control signals. 4K video is supported up to 230 feet (70 meters).

### 2 Mounting

Mount the HD-RX3-C on a flat surface or on a rack rail as appropriate for the installation.

#### Mounting the HD-RX3-C on a Flat Surface

Using four mounting screws (not supplied), attach the HD-RX3-C to a flat surface. Mounting of the HD-RX3-C on a wall is shown below.

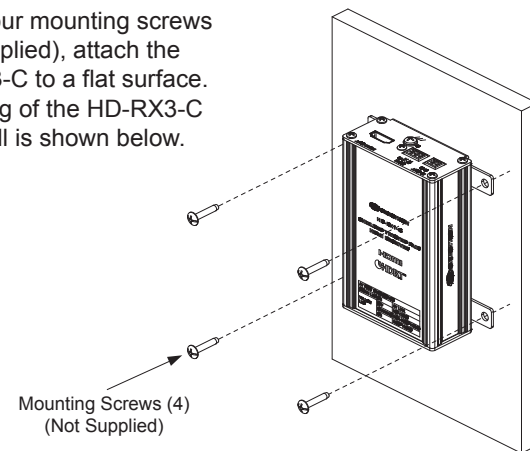

#### Mounting the HD-RX3-C on a Rack Rail

Mount the HD-RX3-C on the front or rear rail of a rack as follows:

1. Position either the left or right mounting flanges of the device so that the holes align with the holes in the rack (mounting of right mounting flanges is shown below).
2. Secure the device to the rack using two rack mounting screws (not supplied).

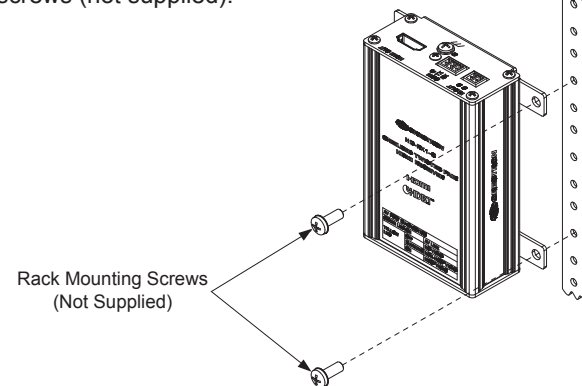

### 3 Connections

#### Connecting to Ground

Connect the chassis ground lug on the HD-RX3-C to earth ground (building steel).

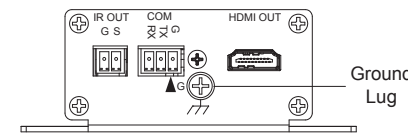

#### Connecting the HDMI OUT Port

Using an HDMI cable (not supplied), connect the **HDMI OUT** port to the HDMI input port of the receiving device.

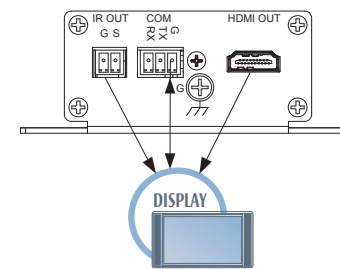

#### Connecting the Control Ports

Connect the **IR OUT** or **COM** control port or both as follows:

- **IR OUT:** Using the Crestron IRP2 emitter (sold separately), connect the 2-pin terminal block of the **IR OUT** port to the IR sensor window of the device to be controlled.
- **COM (RS-232):** Using a data communications cable (not supplied), connect the 3-pin terminal block of the **COM** port to the COM port of the device to be controlled.

#### Connecting the HDBaseT IN Port

Connect the **HDBaseT IN** port to any of the following:

- HDBaseT **OUT** port on the HD-TX3-C
- DM 8G+™ output of a DM® switcher or DM 8G+ transmitter
- Third-party HDBaseT compliant source

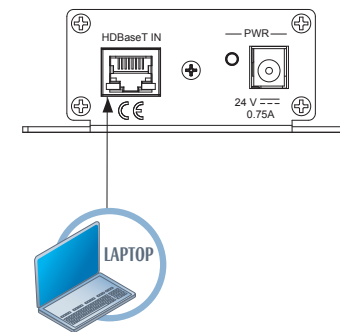

For resolutions up to 1600 x 1200 and 1920 x 1200 (including 1080p60 and 2K), maximum wire length is 330 feet (100 meters) using Crestron DM-CBL-8G, DM-CBL, DM-CBL-D, or third-party CAT5e (or better) UTP or STP cable. For higher resolutions (including 4K), maximum wire length is 230 feet (70 meters) using DM-CBL-8G or 165 feet (50 meters) using DM-CBL, DM-CBL-D, or third-party CAT5e cable. (All wire and cables are sold separately.)

**NOTE:** Shielded cable and connectors are recommended to safeguard against unpredictable environmental electrical noise which may impact performance at resolutions above 1080p.

DM-CBL-8G cable is recommended for optimum performance and ESD (electrostatic discharge) protection.

#### Connecting the 24 Vdc Power Connector

Connect the 24 Vdc power connector as follows:

- If the HD-RX3-C connects to an HD-TX3-C, connect only one 24 Vdc power pack (supplied) to either the HD-RX3-C or HD-TX3-C. Only one power pack is required to power both the HD-RX3-C and HD-TX3-C. Power is transmitted over the cable that connects the HDBaseT ports of the HD-RX3-C and HD-TX3-C.
- If the HD-RX3-C connects to a DM 8G+ output or to a third-party HDBaseT compliant source, connect the supplied power pack to the HD-RX3-C.

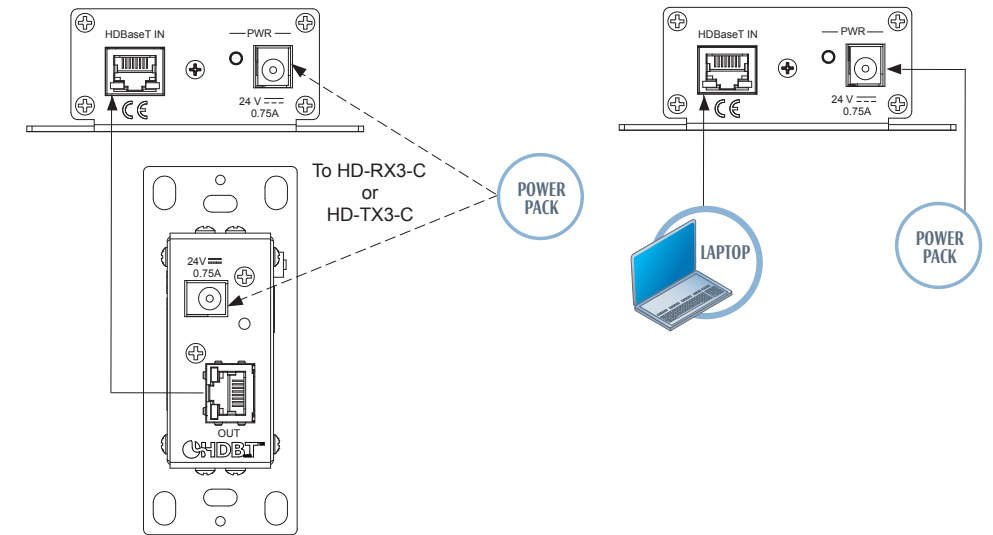

### 4 LED Indicators

LED indicators are provided on the HD-RX3-C.

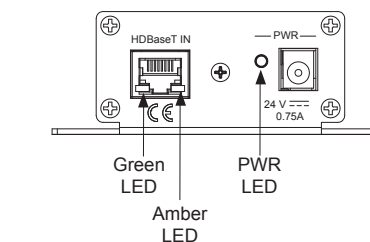

LED INDICATOR	COLOR	DESCRIPTION
HDBaseT IN	Green	A link is established with the HD-TX3-C, DM 8G+, or third-party HDBaseT compliant device.
	Blinking amber	Non-HDCP video is detected.
	Solid amber	HDCP video is detected.
	Amber off	HDMI video is not detected.
PWR	Green	The HD-RX3-C is powered on.
	Off	The HD-RX3-C is not powered on.

The specific patents that cover Crestron products are listed at patents.crestron.com.

Crestron, the Crestron logo, DM, and DM 8G+ are either trademarks or registered trademarks of Crestron Electronics, Inc. in the United States and/or other countries. HDBaseT and the HDBaseT Alliance logo are either trademarks or registered trademarks of the HDBaseT Alliance in the United States and/or other countries. HDMI and the HDMI logo are either trademarks or registered trademarks of HDMI Licensing LLC in the United States and/or other countries. Other trademarks, registered trademarks, and trade names may be used in this document to refer to either the entities claiming the marks and names or their products. Crestron disclaims any proprietary interest in the marks and names of others. Crestron is not responsible for errors in typography or photography.  
©2014 Crestron Electronics, Inc.

For regulatory compliance information, refer to Doc. 7485.

QUICKSTART DOC. 7484B (2035791) 05.14

www.crestron.com | 888.273.7876 | 201.767.3400

Specifications subject to change without notice.

