

MPC3/MPB3-TTK-SQR-SMK

Swivel Mount Kit for MPC3/MPB3-TTK-SQR

The Crestron® MPC3/MPB3-TTK-SQR-SMK provides a means to permanently mount the MPC3/MPB3-TTK-SQR tabletop kit enclosure to a table, desk, or countertop surface while retaining the ability to rotate the enclosure. The swivel range may be customized with optional limiting screws, allowing for a rotation range up to 330 degrees.

Check the Box

| Item | Qty |
|--|-----|
| MPC3/MPB3-TTK-SQR-SMK | 1 |
| Nut, 1-14 (P/N 2047864) | 2 |
| Screw, 6-32 x 3/8 in., Undercut Head, Phillips (P/N 2007235) | 2 |
| Screw, 8-8B x 1/2 in., Pan Head, Phillips (P/N 2017784) | 6 |
| Screw, 8-32 x 1/8 in., Cap Head, Socket (P/N 2017634) | 2 |
| Stop Plate, Swivel, with Screws (P/N 4525464) | 1 |
| Template, Cutout (P/N 4525803) | 1 |
| Washer, Cork, 1.75 in. OD, 1.06 in. ID, 0.063 in. TH (P/N 2047823) | 1 |
| Washer, Felt, 2.10 in. x 1.80 in. ID (P/N 2051165) | 1 |
| Washer, Flat, Steel, 1.75 in. OD, 1.06 in. ID, 0.10 in. TH (P/N 2047812) | 1 |
| Washer, Keyed, 1.06 in. ID (P/N 4525459) | 1 |
| Washer, Rubber, 1.75 in. OD, 1.06 in. ID, 0.063 in. TH (P/N 2047824) | 1 |

Install the Swivel Mount Kit

Prepare the Mounting Surface

- Prepare the mounting surface using the provided cutout template:
 - Secure the included template to a mounting location that allows the device to pivot fully on the surface.
 - Ensure that the arrow on the template points toward the front edge of the mounting surface.
 - The mounting surface must have a thickness of 1 in. (25 mm) to 1-3/8 in. (34 mm).
- Use an appropriate table saw to cut a 1-1/16 in. (27 mm) hole for the swivel mechanism tube into the mounting surface at the marked location on the template.

Attach the Swivel Tube to the MPC3/MPB3-TTK-SQR

- Route all device cables into the swivel mechanism tube from the top so that they exit the bottom of the tube.

NOTE: Route thicker cables first, followed by thinner cables.
- Attach the mounting plate of the swivel mechanism tube to the bottom of the MPC3/MPB3-TTK-SQR enclosure with the two included 6-32 x 3/8 in. screws.
- Remove the adhesive covering from the included felt washer.
- Slide the felt washer up and over the swivel mechanism tube, adhesive side first, and then affix the adhesive to the bottom of the tube mounting plate.

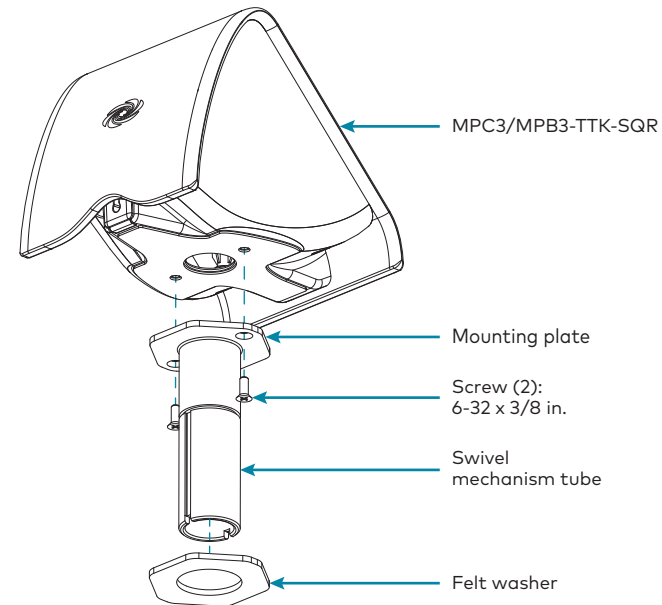

Secure the Swivel Mount to the Mounting Surface

- Use the cutout template as a guide to attach the swivel stop plate to the bottom of the mounting surface with the six included 8-8B x 1/2 in. screws. Refer to the illustration on the following page for mounting hole locations on the swivel stop plate.
- Pass the device cables and the swivel mechanism tube down through the cutout hole and stop plate.



- Slide the provided mounting hardware up and over the swivel tube in the order shown in the illustration below.

NOTE: The keyed metal washer fits onto the swivel tube in one of two orientations: facing forward, or facing away from the permanently installed limiting screw in the swivel stop plate. Orient the tab on the washer to face away from the limiting screw.

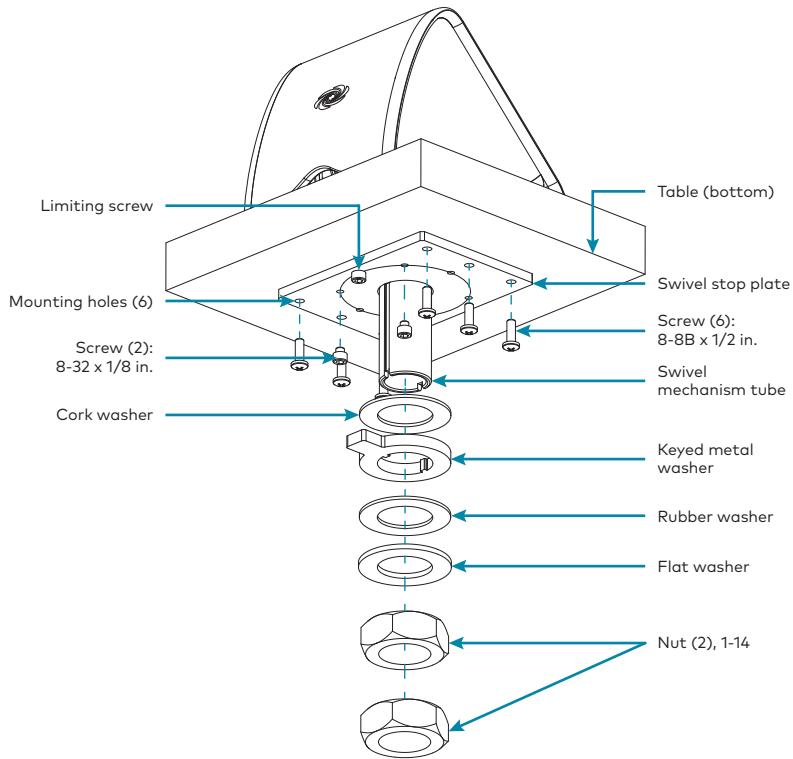

- Tighten and adjust the upper 1-14 nut onto the swivel tube to achieve the desired resistance in the swivel assembly motion.

NOTE: A flat tool (such as a large flat head screwdriver) may be placed in the slot on the bottom of the swivel tube to hold the tube in place while tightening the nut.

- Tighten the lower 1-14 nut manually to prevent the upper nut from slipping.

Customize the Swivel Range

Aside from the permanently installed limiting screw that is attached to the swivel stop plate, two additional 8-32 x 1/8 in. limiting screws (included) can be attached to the swivel mount plate to set a custom range for swivel movement.

Limiting Screw Locations in Swivel Stop Plate

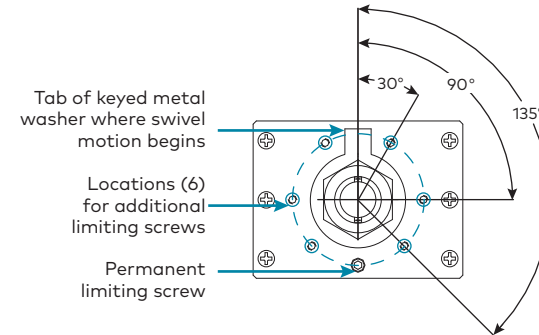

Stop Plate with Additional Limiting Screws

8-32 x 1/8 in. limiting screws (2)
limit swivel to custom range

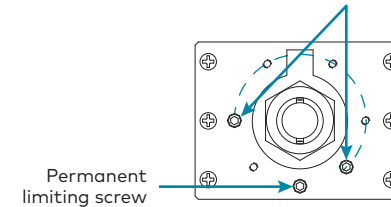

For Additional Information

Scan or click the QR code for detailed product information.



MPC3/MPB3-TTK-SQR-SMK

Compliance and Legal

Original Instructions: The U.S. English version of this document is the original instructions. All other languages are a translation of the original instructions.

The product warranty can be found at www.crestron.com/warranty.

The specific patents that cover Crestron products are listed at www.crestron.com/legal/patents.

Certain Crestron products contain open source software. For specific information, please visit www.crestron.com/opensource.

Crestron and the Crestron logo are either trademarks or registered trademarks of Crestron Electronics, Inc. in the United States and/or other countries. Other trademarks, registered trademarks, and trade names may be used in this document to refer to either the entities claiming the marks and names or their products. Crestron disclaims any proprietary interest in the marks and names of others. Crestron is not responsible for errors in typography or photography.

©2019 Crestron Electronics, Inc.

Crestron Electronics, Inc.
15 Volvo Drive, Rockleigh, NJ 07647
Tel: 888.CRESTRON
Fax: 201.767.7576
www.crestron.com

Quick Start - Doc. 8396B
(2052745)
03.19

Specifications subject to change without notice.